

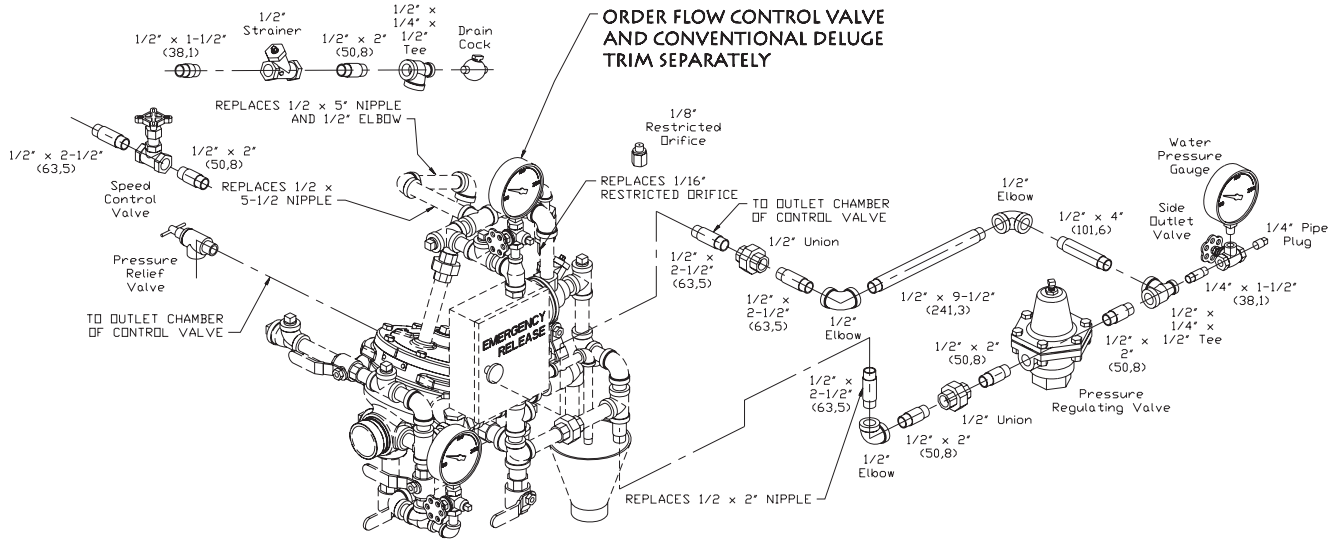

TECHNICAL DATA

PILOT REGULATOR TRIM
 For Viking Straight Through Flow Control Valve with Conventional Deluge Valve Trim and Speed Control Valve
 (Maximum 250 Water Working Pressure)

Manufactured since 2005



Size of Valve	Galvanized		Brass	
	Horizontal	Vertical	Horizontal	Vertical
1-1/2" (40 mm) & 2" (50 mm)	12752-1	12758-1	12752-2	12758-2

Note:
 To ensure proper operation of the Pilot Pressure Regulator Valve, the adjustment screw must engage the pressure spring. See (8.) Installation Instructions on page 531f for proper pressure setting of discharge pressure and application.

Figure A
 Horizontal Deluge Valve Trim

This trim chart and the trim sets listed are for use with Viking Straight Through Flow Control Valves equipped with Conventional Deluge Valve Trim as shown in Figure A or B (this page) or with Conventional Flow Control Trim as shown in Figure A or B on page 536f.

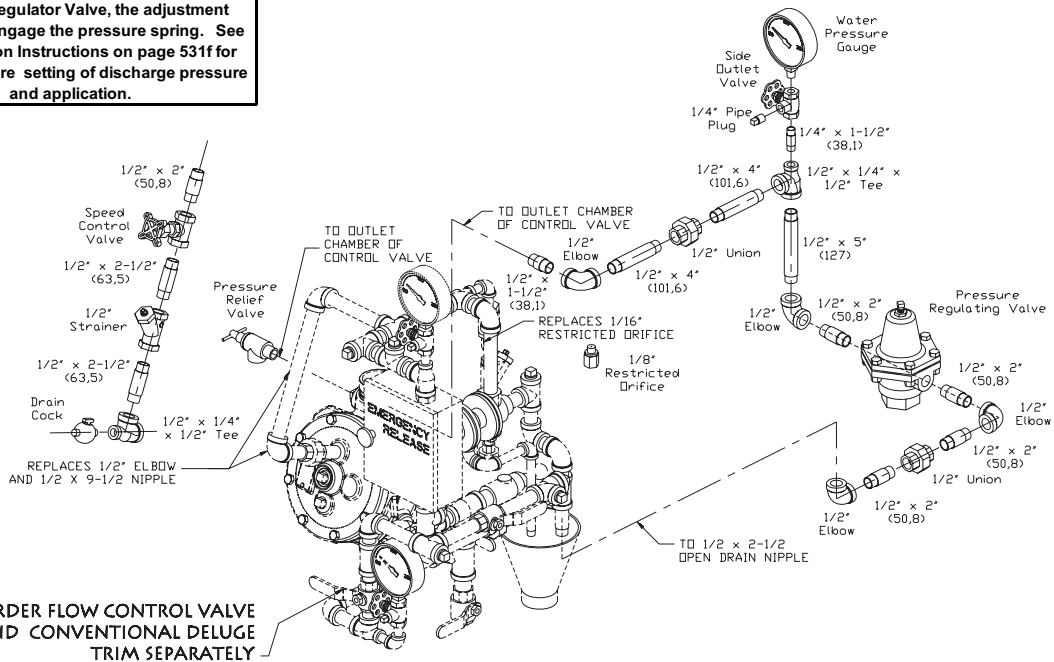

Figure B
 Vertical Deluge Valve Trim



Manufactured since 2005

TECHNICAL DATA

PILOT REGULATOR TRIM

For Viking Straight Through Flow Control Valve with Conventional Deluge Valve Trim and Speed Control Valve
(Maximum 250 Water Working Pressure)

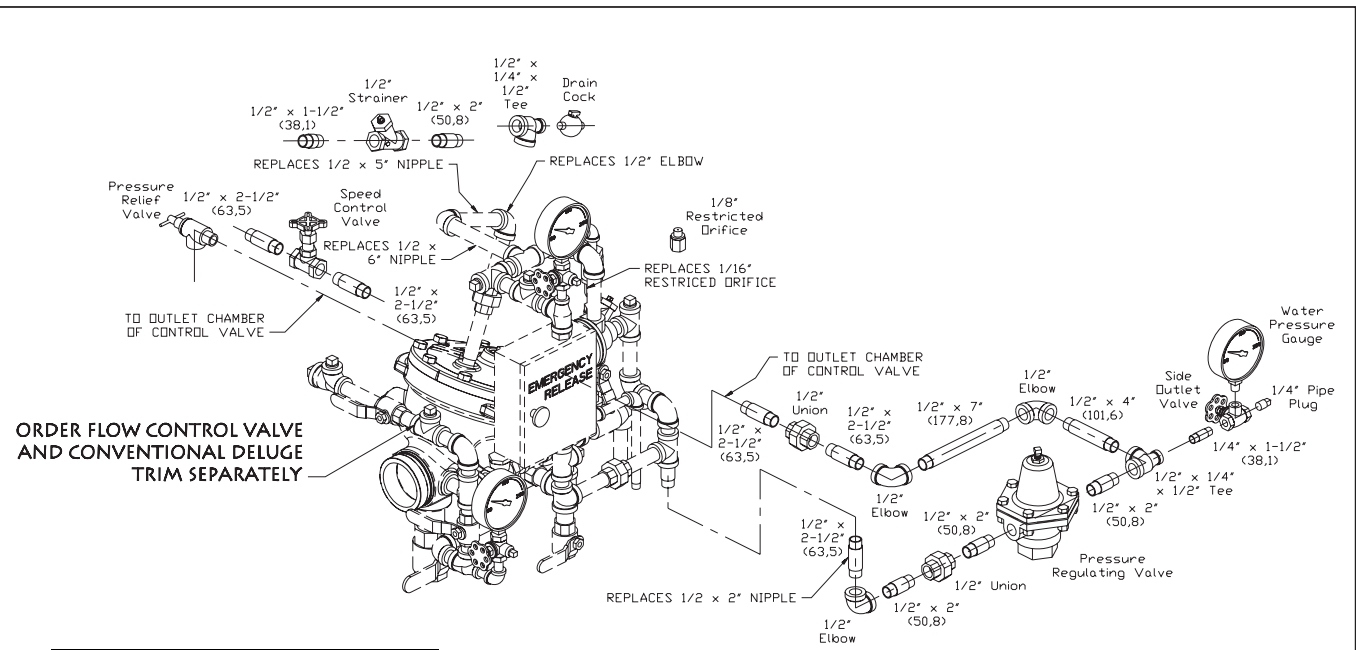

Size of Valve	Galvanized		Brass	
	Horizontal	Vertical	Horizontal	Vertical
2-1/2" (65 mm) & 3" (80 mm)	12753-1	12759-1	12753-2	12759-2

Note:
To ensure proper operation of the Pilot Pressure Regulator Valve, the adjustment screw must engage the pressure spring. See (8.) Installation Instructions on page 531f for proper pressure setting of discharge pressure and application.

Figure C
Horizontal Deluge Valve Trim

This trim chart and the trim sets listed are for use with Viking Straight Through Flow Control Valves equipped with Conventional Deluge Valve Trim as shown in Figure C or D (this page) or with Conventional Flow Control Trim as shown in Figure C or D on page 536g.

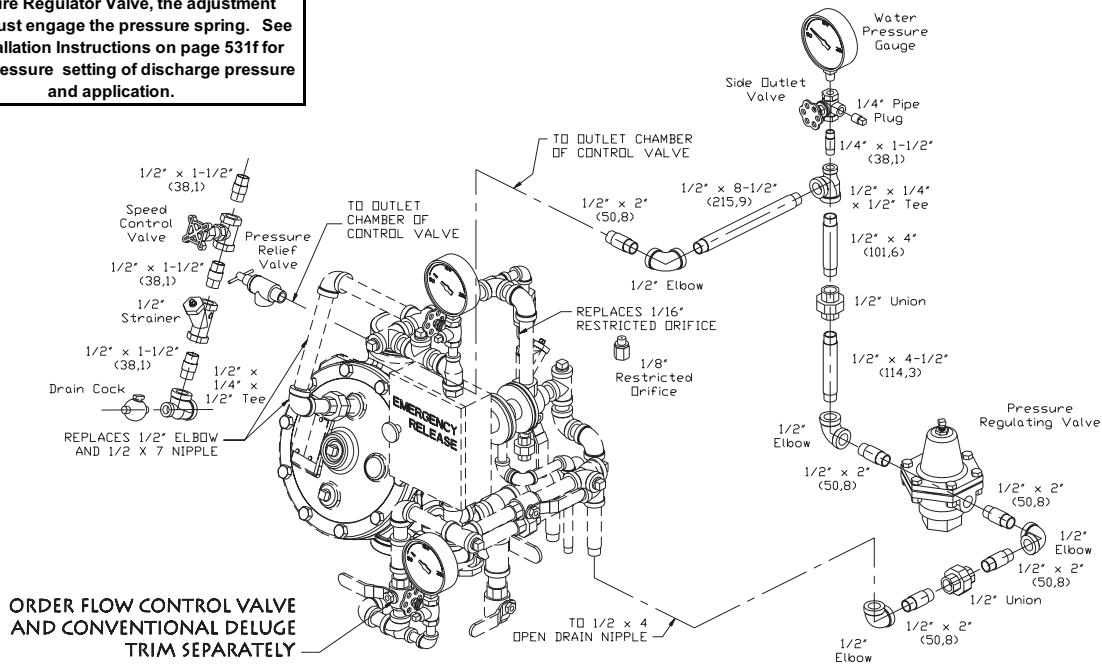

Figure D
Vertical Deluge Valve Trim



TECHNICAL DATA

PILOT REGULATOR TRIM
 For Viking Straight Through Flow Control Valve with Conventional Deluge Valve Trim and Speed Control Valve
 (Maximum 250 Water Working Pressure)

Manufactured since 2005

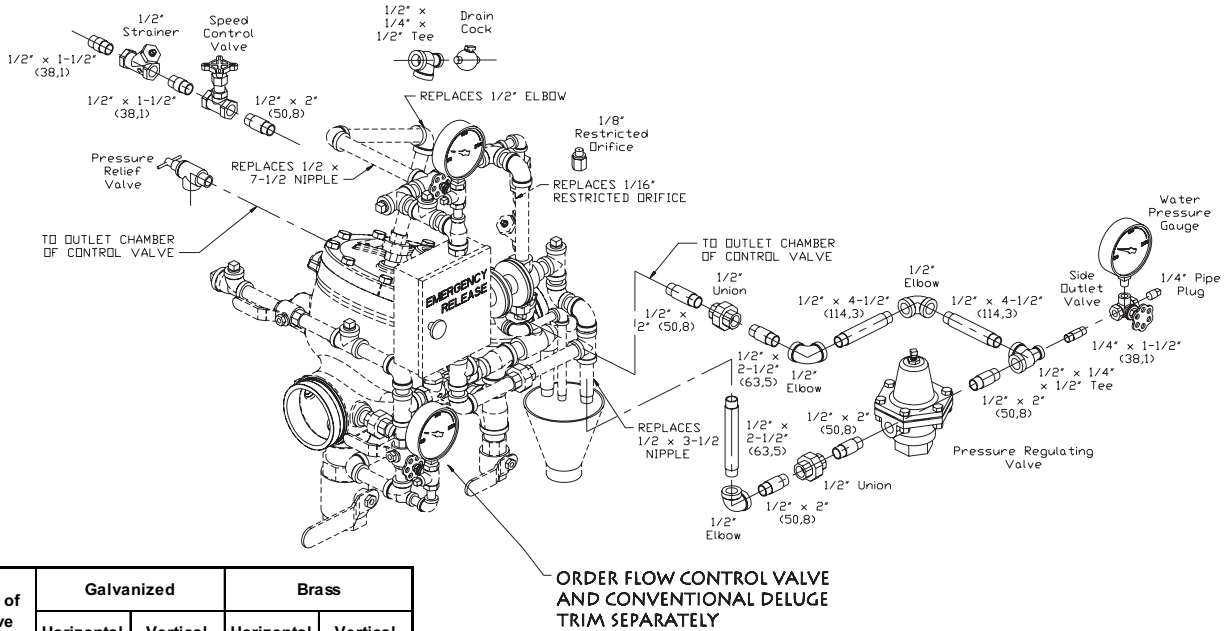

Size of Valve 4" (100 mm)	Galvanized		Brass	
	Horizontal	Vertical	Horizontal	Vertical
	12754-1	12760-1	12754-2	12760-2

Note:
 To ensure proper operation of the Pilot Pressure Regulator Valve, the adjustment screw must engage the pressure spring. See (8.) Installation Instructions on page 531f for proper pressure setting of discharge pressure and application.

Figure E
 Horizontal Deluge Valve Trim

This trim chart and the trim sets listed are for use with Viking Straight Through Flow Control Valves equipped with Conventional Deluge Valve Trim as shown in Figure E or F (this page) or with Conventional Flow Control Trim as shown in Figure E or F on page 536h.

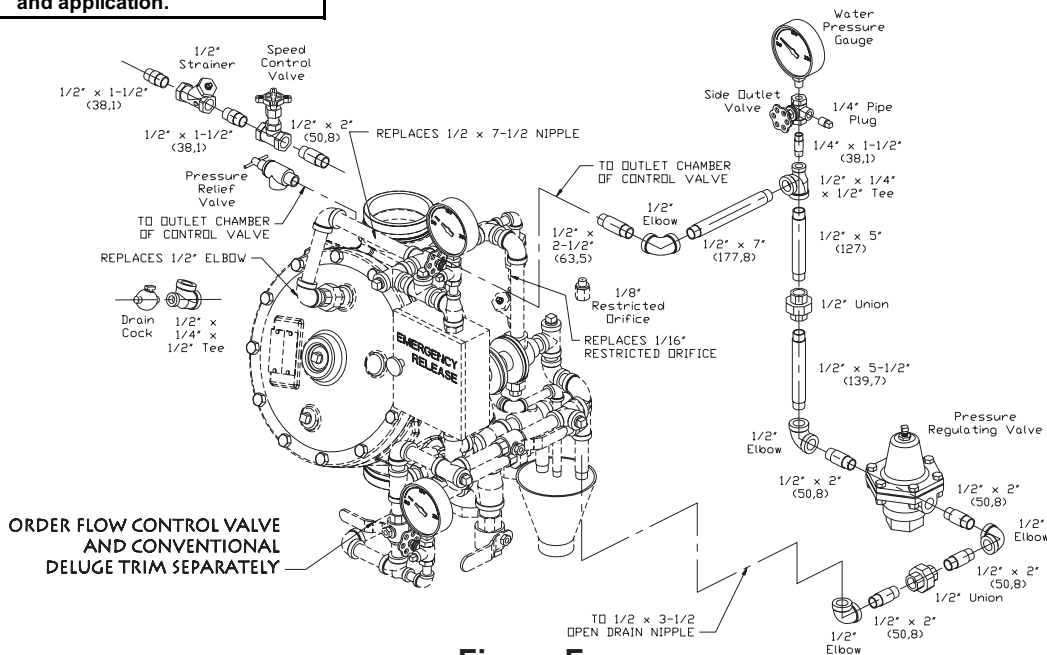

Figure F
 Vertical Deluge Valve Trim



TECHNICAL DATA

PILOT REGULATOR TRIM

For Viking Straight Through Flow Control Valve with Conventional Deluge Valve Trim and Speed Control Valve
(Maximum 250 Water Working Pressure)

Manufactured since 2005

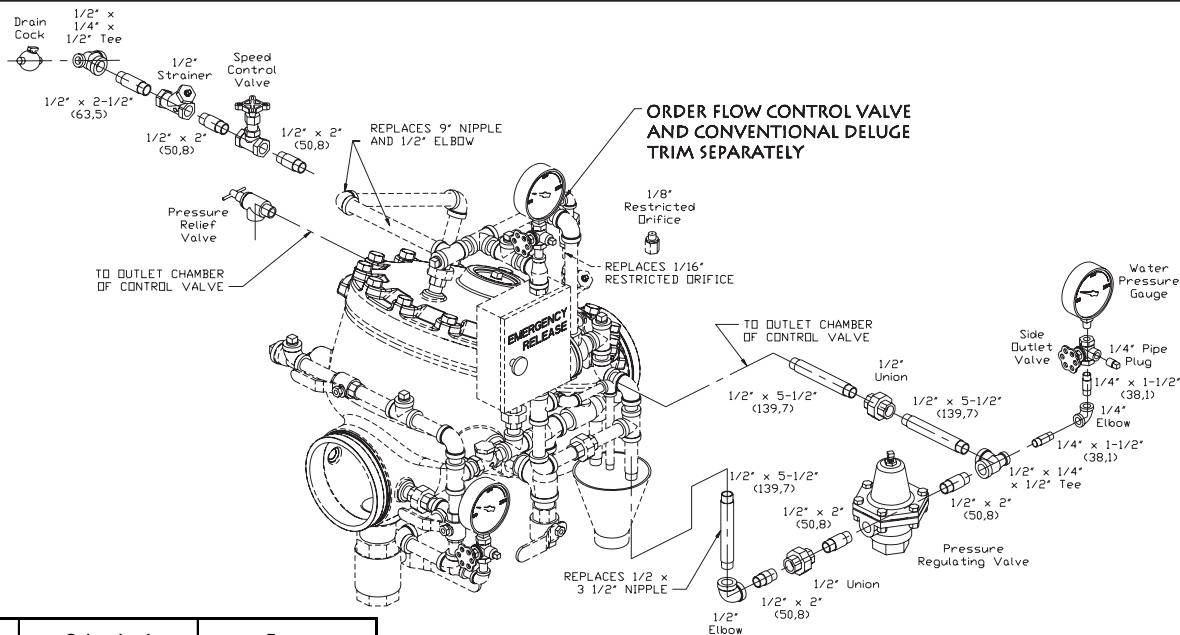

Size of Valve	Galvanized		Brass	
	Horizontal	Vertical	Horizontal	Vertical
6" (150 mm)	12755-1	12761-1	12755-2	12761-2

Note:
To ensure proper operation of the Pilot Pressure Regulator Valve, the adjustment screw must engage the pressure spring. See (8.) Installation Instructions on page 531f for proper pressure setting of discharge pressure and application.

Figure G
Horizontal Deluge Valve Trim

This trim chart and the trim sets listed are for use with Viking Straight Through Flow Control Valves equipped with Conventional Deluge Valve Trim as shown in Figure G or H (this page) or with Conventional Flow Control Trim as shown in Figure G or H on page 536i.

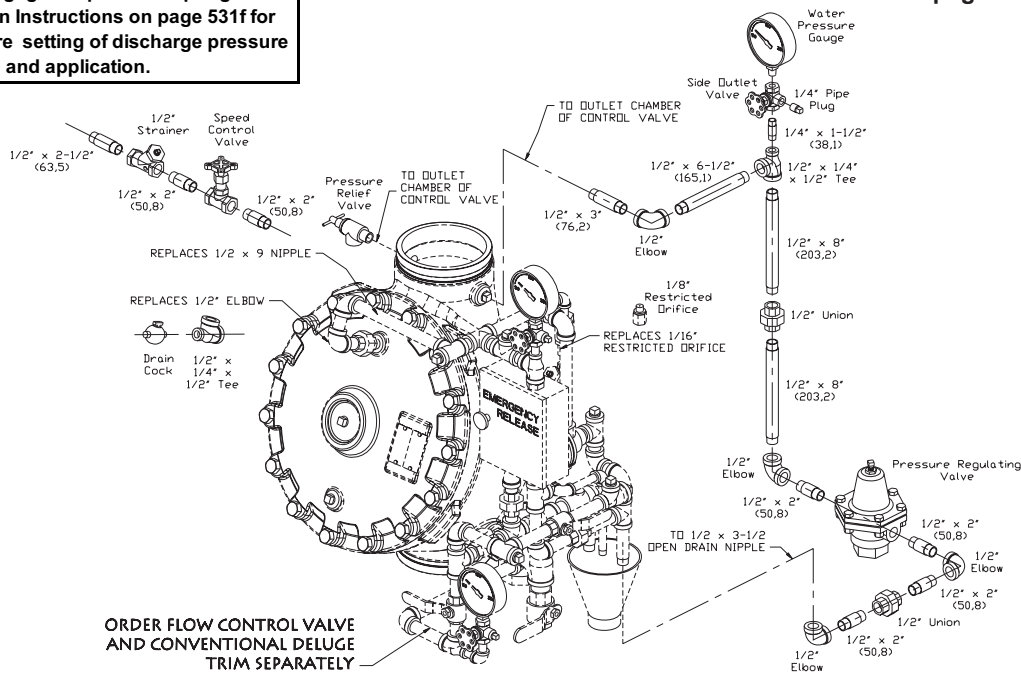

Figure H
Vertical Deluge Valve Trim



TECHNICAL DATA

PILOT REGULATOR TRIM
 For Viking Straight Through Flow Control Valve with Conventional Deluge Valve Trim and Speed Control Valve
 (Maximum 250 Water Working Pressure)

Manufactured since 2005

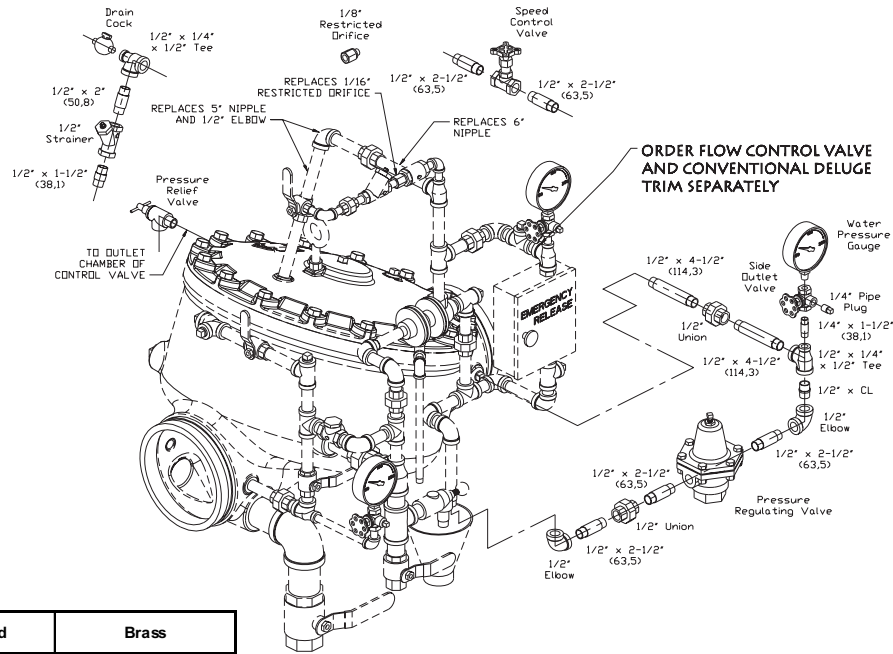

Size of Valve	Galvanized		Brass	
	Horizontal	Vertical	Horizontal	Vertical
8" (200 mm)	12756-1	12762-1	12756-2	12762-2

Note:
 To ensure proper operation of the Pilot Pressure Regulator Valve, the adjustment screw must engage the pressure spring. See (8.) Installation Instructions on page 531f for proper pressure setting of discharge pressure and application.

Figure I
 Horizontal Deluge Valve Trim

This trim chart and the trim sets listed are for use with Viking Straight Through Flow Control Valves equipped with Conventional Deluge Valve Trim as shown in Figure I or J (this page) or with Conventional Flow Control Trim as shown in Figure I or J on page 536j.

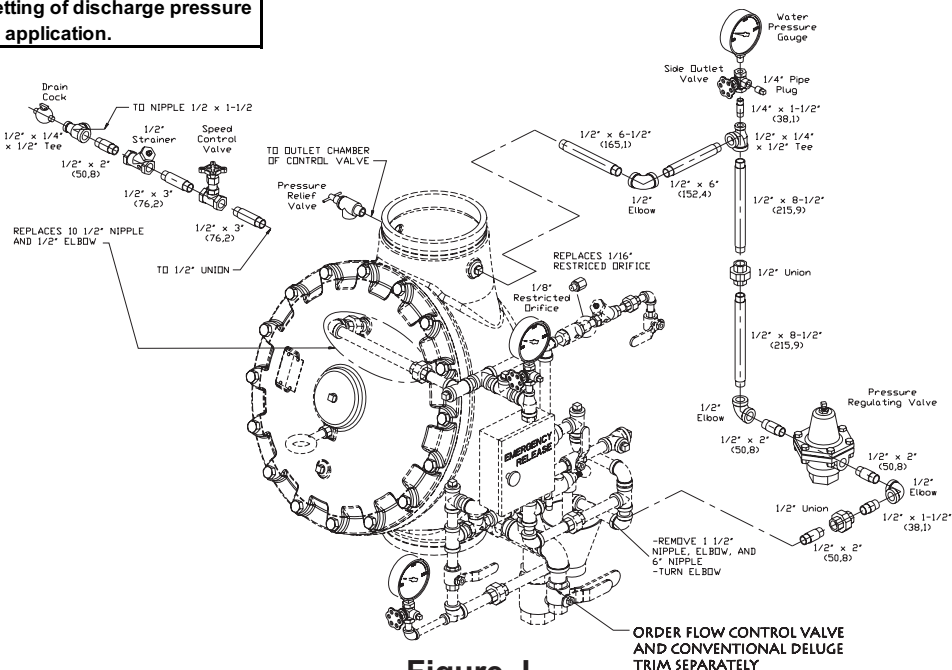

Figure J
 Vertical Deluge Valve Trim



TECHNICAL DATA

PILOT REGULATOR TRIM
 For Viking Straight Through Flow Control Valve with Conventional Flow Control Valve Trim and Speed Control Valve
 (Maximum 250 Water Working Pressure)

Manufactured since 2005

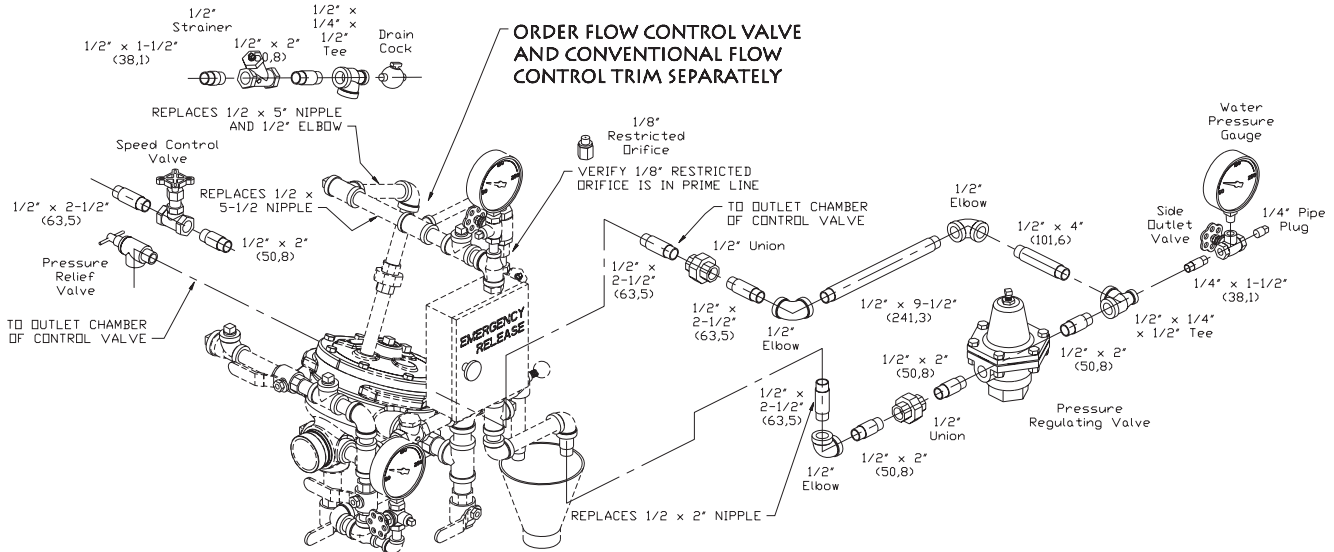

Size of Valve	Galvanized		Brass	
	Horizontal	Vertical	Horizontal	Vertical
1-1/2" (40 mm) & 2" (50 mm)	12752-1	12758-1	12752-2	12758-2

Note:
 To ensure proper operation of the Pilot Pressure Regulator Valve, the adjustment screw must engage the pressure spring. See (8.) Installation Instructions on page 531f for proper pressure setting of discharge pressure and application.

Figure A
 Horizontal Flow Control Valve Trim

This trim chart and the trim sets listed are for use with Viking Straight Through Flow Control Valves equipped with Conventional Flow Control Valve Trim as shown in Figure A or B (this page) or with Conventional Deluge Valve Trim as shown in Figure A or B on page 536a.

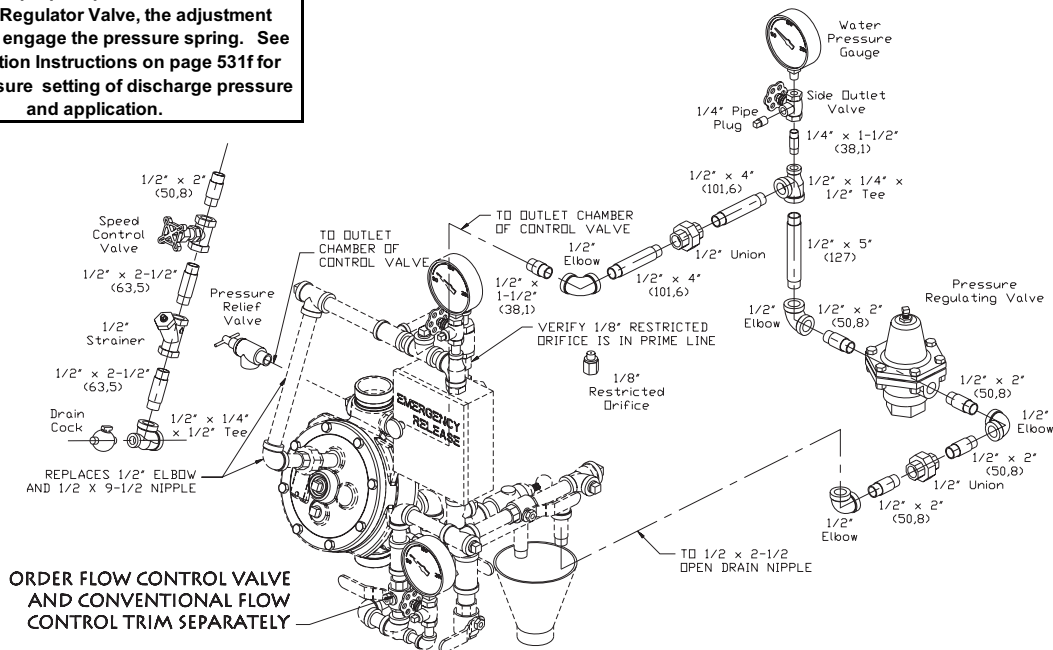

Figure B
 Vertical Flow Control Valve Trim



TECHNICAL DATA

PILOT REGULATOR TRIM
For Viking Straight Through Flow Control Valve with Conventional Flow Control Valve Trim and Speed Control Valve
 (Maximum 250 Water Working Pressure)

Manufactured since 2005

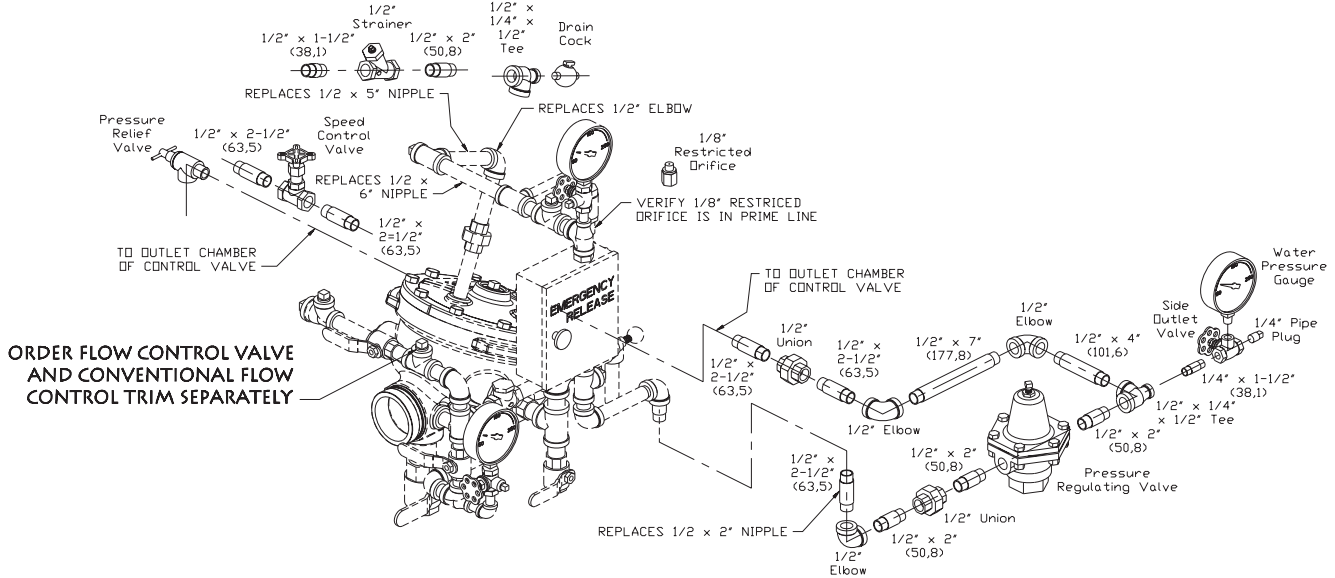

Size of Valve	Galvanized		Brass	
	Horizontal	Vertical	Horizontal	Vertical
2-1/2" (65 mm) & 3" (80 mm)	12753-1	12759-1	12753-2	12759-2

Note:
 To ensure proper operation of the Pilot Pressure Regulator Valve, the adjustment screw must engage the pressure spring. See (8.) Installation Instructions on page 531f for proper pressure setting of discharge pressure and application.

Figure C
Horizontal Flow Control Valve Trim

This trim chart and the trim sets listed are for use with Viking Straight Through Flow Control Valves equipped with Conventional Flow Control Valve Trim as shown in Figure C or D (this page) or with Conventional Deluge Valve Trim as shown in Figure C or D on page 536b.

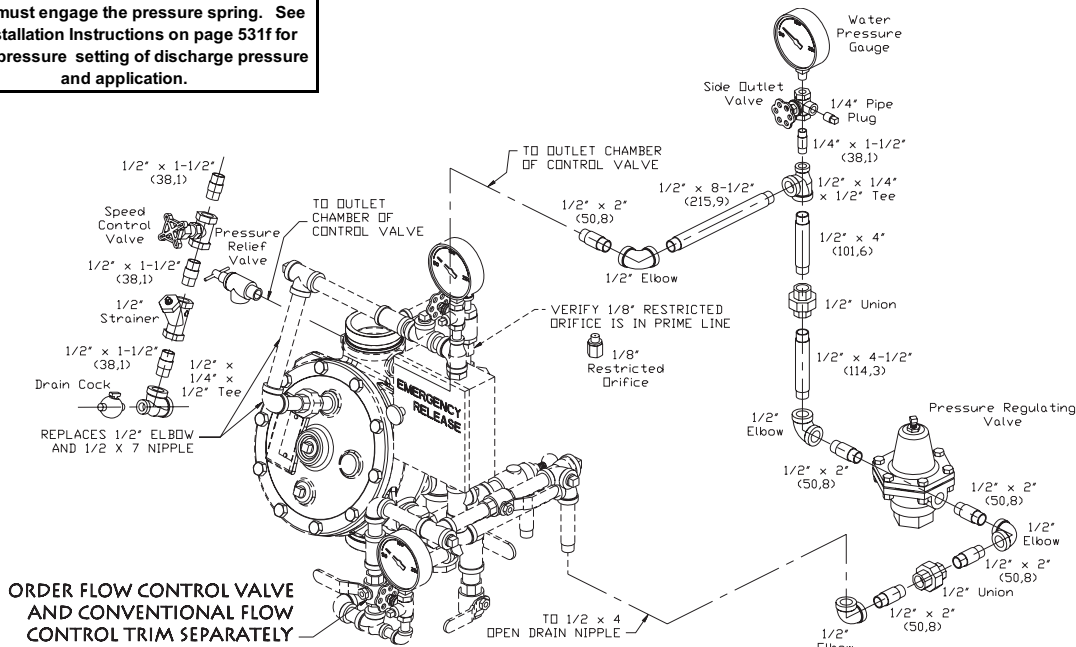

Figure D
Vertical Flow Control Valve Trim



TECHNICAL DATA

PILOT REGULATOR TRIM

For Viking Straight Through Flow Control Valve with Conventional Flow Control Valve Trim and Speed Control Valve
(Maximum 250 Water Working Pressure)

Manufactured since 2005

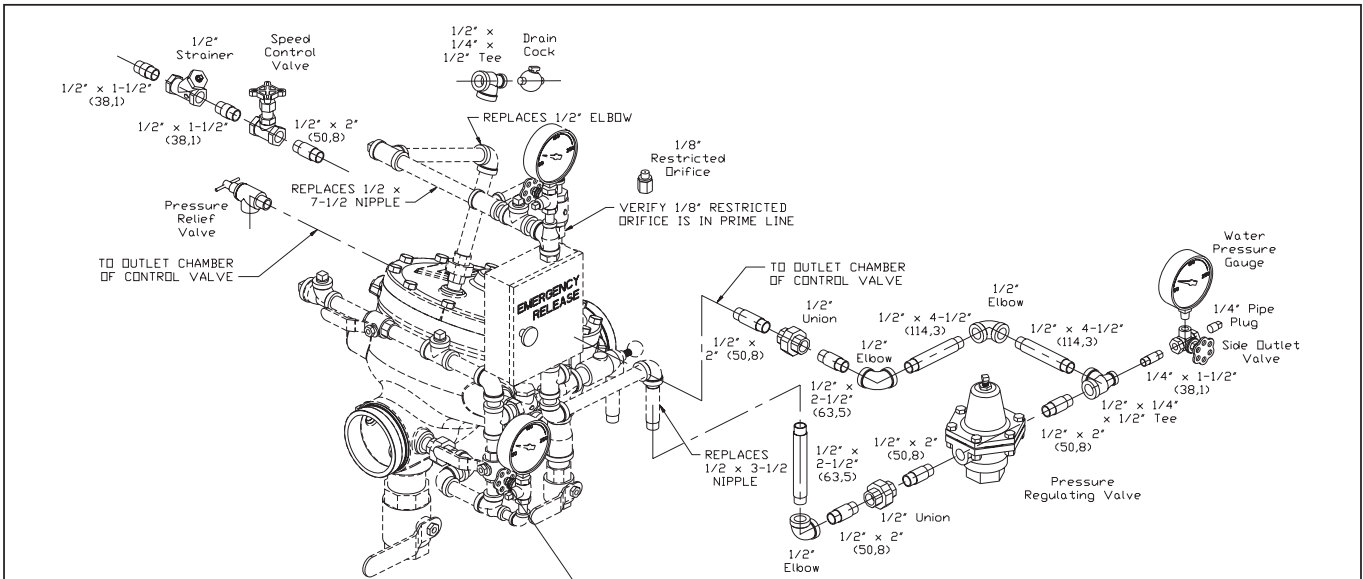

Size of Valve	Galvanized		Brass	
	Horizontal	Vertical	Horizontal	Vertical
4" (100 mm)	12754-1	12760-1	12754-2	12760-2

Note:
To ensure proper operation of the Pilot Pressure Regulator Valve, the adjustment screw must engage the pressure spring. See (8.) Installation Instructions on page 531f for proper pressure setting of discharge pressure and application.

ORDER FLOW CONTROL VALVE AND CONVENTIONAL FLOW CONTROL TRIM SEPARATELY

This trim chart and the trim sets listed are for use with Viking Straight Through Flow Control Valves equipped with Conventional Flow Control Valve Trim as shown in Figure E or F (this page) or with Conventional Deluge Valve Trim as shown in Figure E or F on page 536c.

Figure E
Horizontal Flow Control Valve Trim

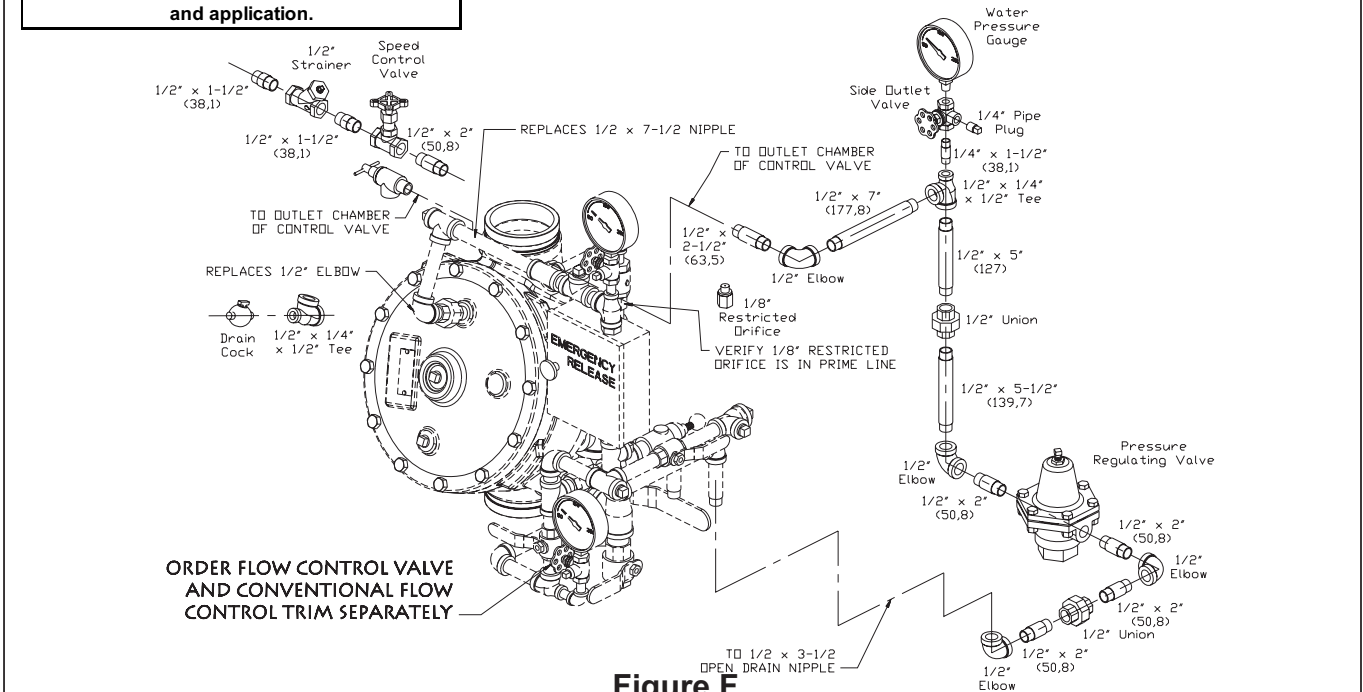

ORDER FLOW CONTROL VALVE AND CONVENTIONAL FLOW CONTROL TRIM SEPARATELY

Figure F
Vertical Flow Control Valve Trim



TECHNICAL DATA

PILOT REGULATOR TRIM
 For Viking Straight Through Flow Control Valve with Conventional Flow Control Valve Trim and Speed Control Valve
 (Maximum 250 Water Working Pressure)

Manufactured since 2005

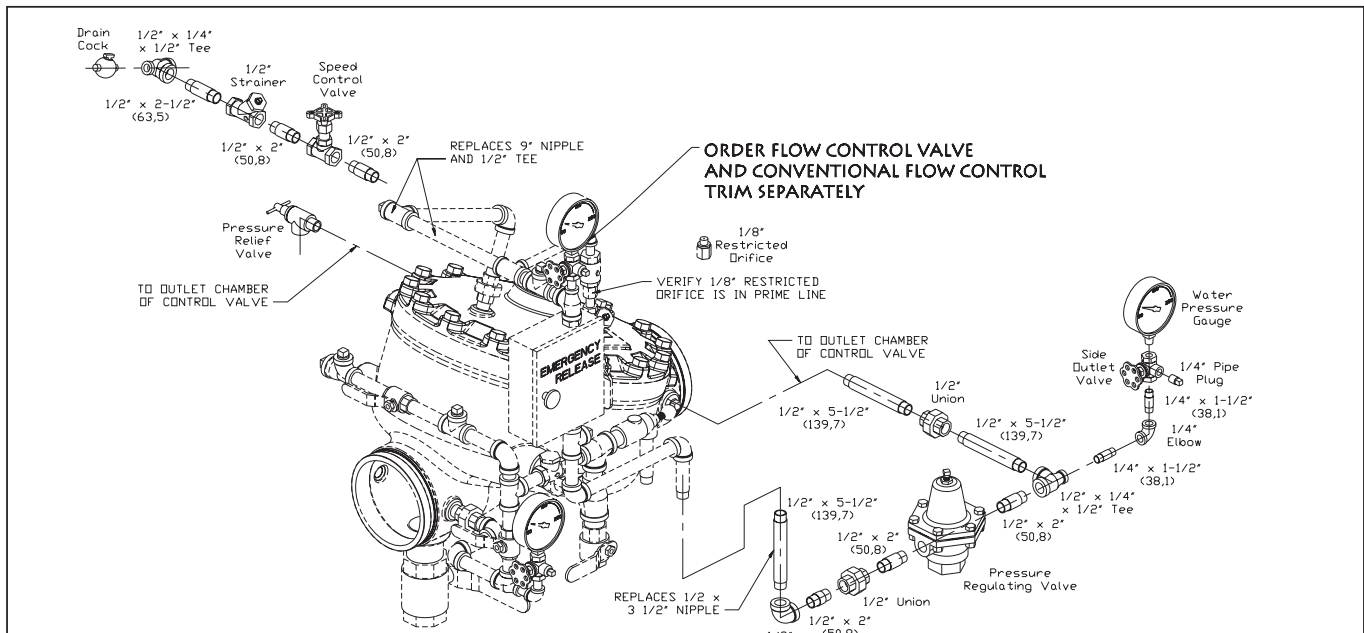

Size of Valve 6" (150 mm)	Galvanized		Brass	
	Horizontal	Vertical	Horizontal	Vertical
	12755-1	12761-1	12755-2	12761-2

Note:
 To ensure proper operation of the Pilot Pressure Regulator Valve, the adjustment screw must engage the pressure spring. See (8.) Installation Instructions on page 531f for proper pressure setting of discharge pressure and application.

Figure G
 Horizontal Flow Control Valve Trim

This trim chart and the trim sets listed are for use with Viking Straight Through Flow Control Valves equipped with Conventional Flow Control Valve Trim as shown in Figure G or H (this page) or with Conventional Deluge Valve Trim as shown in Figure G or H on page 536d.

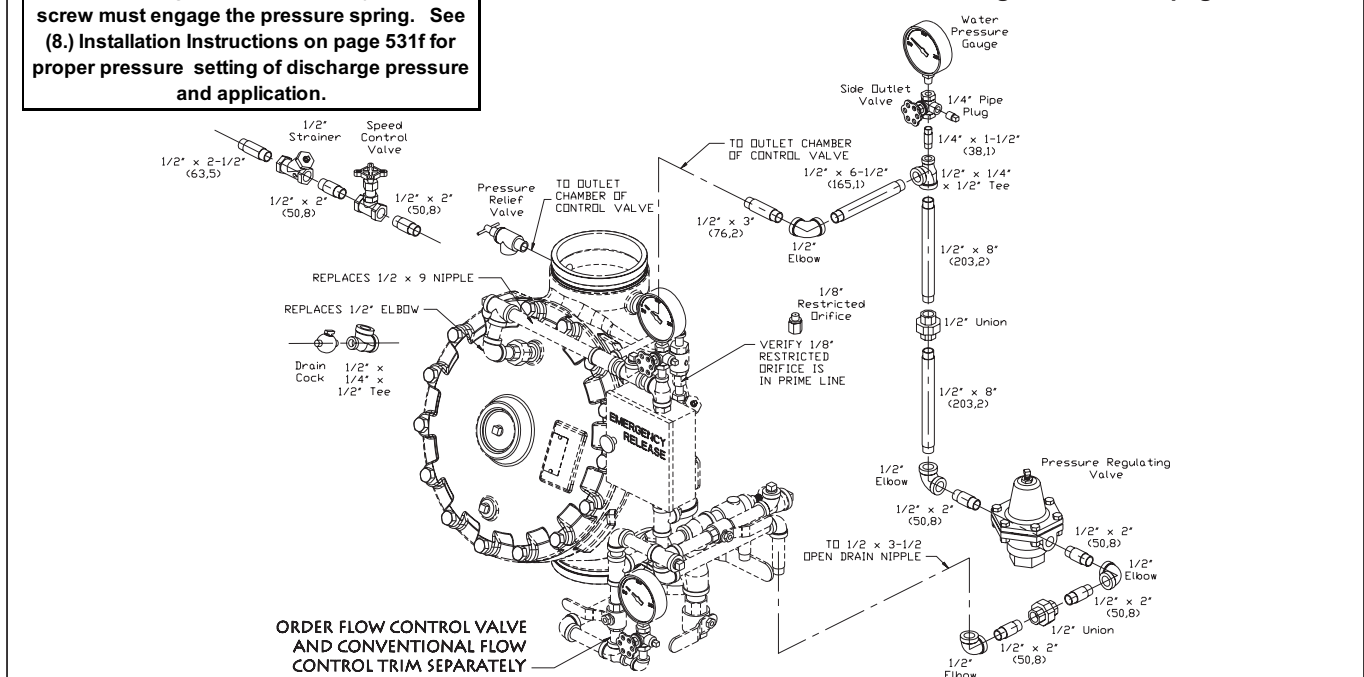

Figure H
 Vertical Flow Control Valve Trim



TECHNICAL DATA

PILOT REGULATOR TRIM
 For Viking Straight Through Flow Control Valve with Conventional Flow Control Valve Trim and Speed Control Valve
 (Maximum 250 Water Working Pressure)

Manufactured since 2005

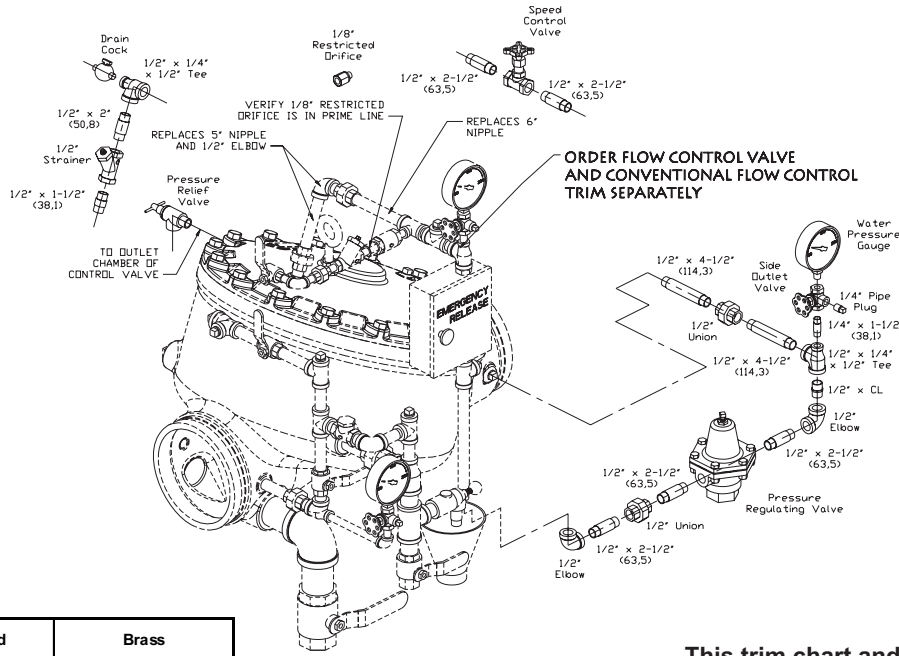

Size of Valve	Galvanized		Brass	
	Horizontal	Vertical	Horizontal	Vertical
8" (200 mm)	12756-1	12762-1	12756-2	12762-2

Note:
 To ensure proper operation of the Pilot Pressure Regulator Valve, the adjustment screw must engage the pressure spring. See (8.) Installation Instructions on page 531f for proper pressure setting of discharge pressure and application.

Figure I
Horizontal Flow Control Valve Trim

This trim chart and the trim sets listed are for use with Viking Straight Through Flow Control Valves equipped with Conventional Flow Control Valve Trim as shown in Figure I or J (this page) or with Conventional Deluge Valve Trim as shown in Figure I or J on page 536e.

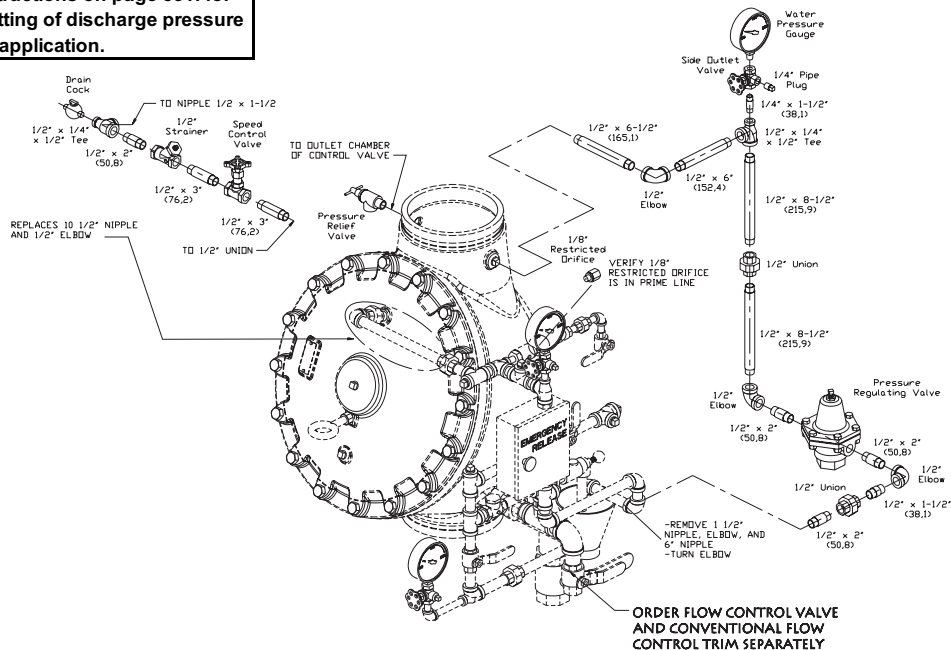

Figure J
Vertical Flow Control Valve Trim