

Class 125 (Standard)

FIG. 3356

45° Elbow

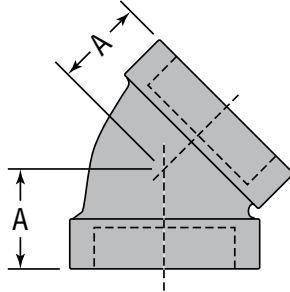

For Listings/Approval Details and Limitations, visit our website at www.anvilintl.com or contact an Anvil® Sales Representative.

FIGURE 3356 - 45° ELBOW

| Nominal Size | Maximum Working Pressure▲ | Dimension A | Approx. Wt. Each |
|-----------------|---------------------------|-----------------|------------------|
| <i>In. (mm)</i> | <i>PSI (kPa)</i> | <i>In. (mm)</i> | <i>Lbs. (kg)</i> |
| 1 | 300 | 1.12 | 0.84 |
| 25 | 2065 | 28.448 | 0.38 |
| 1¼ | 300 | 1.29 | 1.40 |
| 32 | 2065 | 32.766 | 0.64 |
| 1½ | 300 | 1.43 | 1.80 |
| 40 | 2065 | 36.322 | 0.82 |
| 2 | 300 | 1.68 | 2.79 |
| 50 | 2065 | 42.672 | 1.25 |

▲ – Working Pressure Ratings are for reference only and based on Sch. 40 pipe. For the latest UL/ULC, and FM pressure ratings versus pipe schedule, please visit anvilintl.com or contact your local Anvil Representative.

MATERIAL SPECIFICATIONS

Dimensions: ASME B16.4 Class 125

Material: ASTM A126

Finish: Black or Hot Dip Galvanized per ASTM A153 Class A

Threads: NPT per ASME B1.20.1

Agency Approvals: All cast iron threaded fittings are UL/ULC Listed and FM Approved.

PROJECT INFORMATION

APPROVAL STAMP

| | |
|-----------------|--|
| Project: | <input type="checkbox"/> Approved |
| Address: | <input type="checkbox"/> Approved as noted |
| Contractor: | <input type="checkbox"/> Not approved |
| Engineer: | Remarks: |
| Submittal Date: | |
| Notes 1: | |
| Notes 2: | |