

Class 125 (Standard)

FIG. 3360R

Reducing Cross

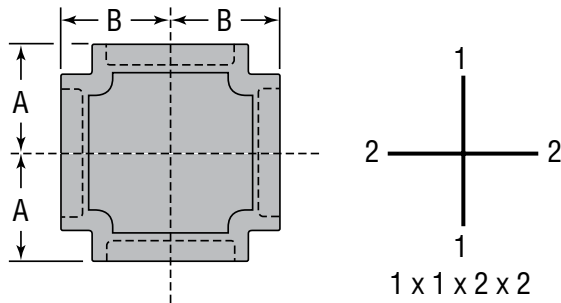

For Listings/Approval Details and Limitations, visit our website at www.anvilintl.com or contact an Anvil® Sales Representative.

FIGURE 3360R - REDUCING CROSS

| Nominal Size 1 x 1 x 2 x 2 | Max. Working Pressure▲ PSI (kPa) | Dimensions | | Approx. Wt. Each Lbs. (kg) |
|--------------------------------------|-------------------------------------|---------------|---------------|-------------------------------|
| | | A In. (mm) | B In. (mm) | |
| 1¼ x 1¼ x 1 x 1 32 x 32 x 25 x 25 | 300 2065 | 1.58 40.13 | 1.67 42.41 | 2.05 0.93 |
| 1½ x 1½ x 1 x 1 40 x 40 x 25 x 25 | 300 2065 | 1.65 41.91 | 1.80 45.72 | 2.40 1.09 |
| 2 x 2 x 1 x 1 50 x 50 x 25 x 25 | 300 2065 | 1.73 38.60 | 2.02 44.45 | 2.75 1.25 |

▲ – Working Pressure Ratings are for reference only and based on Sch. 40 pipe. For the latest UL/ULC, and FM pressure ratings versus pipe schedule, please visit anvilintl.com or contact your local Anvil Representative.

MATERIAL SPECIFICATIONS

Dimensions: ASME B16.4 Class 125

Material: ASTM A126

Finish: Black or Hot Dip Galvanized per ASTM A153 Class A

Threads: NPT per ASME B1.20.1

Agency Approvals: All cast iron threaded fittings are UL/ULC Listed and FM Approved.

PROJECT INFORMATION

APPROVAL STAMP

| | |
|-----------------|--|
| Project: | <input type="checkbox"/> Approved |
| Address: | <input type="checkbox"/> Approved as noted |
| Contractor: | <input type="checkbox"/> Not approved |
| Engineer: | Remarks: |
| Submittal Date: | |
| Notes 1: | |
| Notes 2: | |