



REPLACEMENT PARTS

ACCELERATOR  
MODEL D-2

Manufactured 1998 -

ITEM NO.	PART NUMBER	DESCRIPTION	MATERIAL	NO. REQ'D
1	--	Cover	Brass Casting	1
2	05480B	Cover Diaphragm Assembly	Various, Nitrile	1
3	*	Retaining Ring	Stainless Steel 157	1
4	*	Actuator Rod	Brass Rod	1
5	*	Actuator Rod Spring	Stainless Steel 302	1
6	*	Housing Insert	Brass UNS-C36000	1
7	--	Housing	Brass Casting	1
8	05105S	1/8" Pipe Plug	Steel	1
9	*	Screen Filter	Stainless Steel 304	1
10	*	U-Cup	Buna-N	2
11	*	U-Cup Retainer	Stainless Steel 302/304	2
12	*	Housing Spring	Stainless Steel 302	1
13	*	Clapper Diaphragm	Polyethersulfone/EPDM	1
14	*	Seat	Brass Rod UNS-C36000	1
15	--	Base	Brass Casting	1
16a & 16b	16972	Screw, S.H. 1/4"-20 UNC x 1"	Zinc Plated	8
17	05472A	Locating Pin	Stainless Steel 304	1
18	*	Lithium Grease	Lithium Grease	3/8 oz.
Not Shown				
-- Indicates replacement part not available				
* Indicates replacement part only available in a Sub-Assembly listed below.				
SUB-ASSEMBLIES				
2-6, 9-14, 18-19	14834	Repair Kit - Includes Air Gauge		
19	06057A	Anti-Flood Kit		
<b>Note:</b> 14834 Repair Kit includes a cover gasket that is not used on the D-2 Accelerator.				

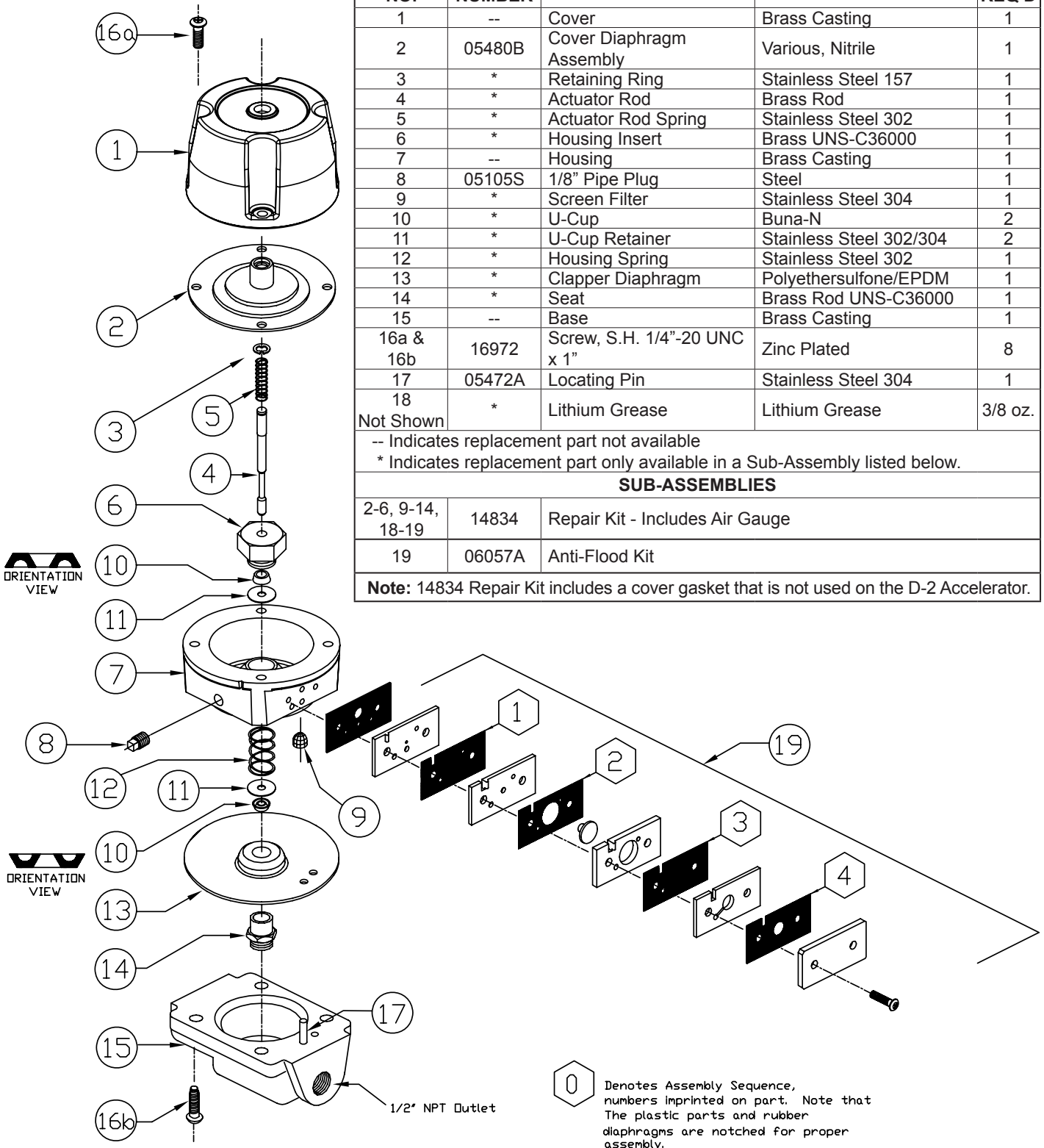

0 Denotes Assembly Sequence, numbers imprinted on part. Note that The plastic parts and rubber diaphragms are notched for proper assembly.