

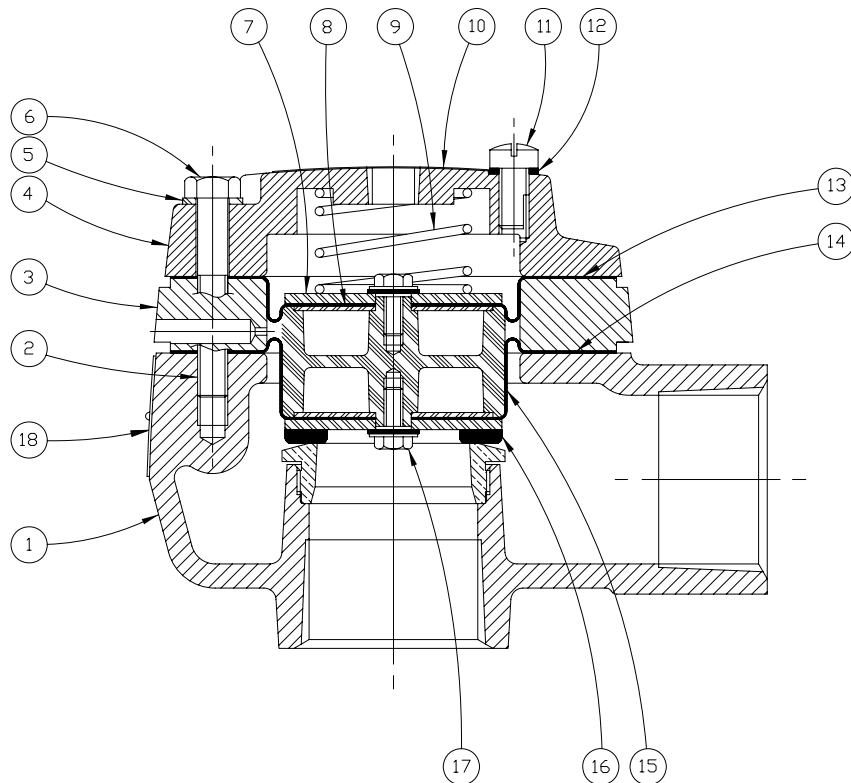

REPLACEMENT PARTS

**FLOW CONTROL VALVE
HALAR® COATED MODEL H-4
1-1/2" (DN40)**

Manufactured 1994 - 2012



ITEM NO.	PART NUMBER	DESCRIPTION	MATERIAL	NO. REQ'D.
1	--	Body	Ductile Iron 65-45-12, Halar® Coated	1
2	08318	Lithium Grease	Lithium Grease	--
3	--	Spacer	Ductile Iron 65-45-12, Halar® Coated	1
4	--	Cover	Ductile Iron 60-40-18, Halar® Coated	1
5	--	Washer	Stainless Steel	4
6	04838A	Screw, H.H.C., 5/16-18 x 2" Lg.	Stainless Steel	4
7	04211A	Clamp Plate	Stainless Steel UNS-S30400 12 ga.	1
8	04692A	End Plate	Stainless Steel UNS-S30400 18 ga.	2
9	09320	Spring	Stainless Steel UNS-30200	1
10	--	Cover Label	Aluminum	1
11	--	Vent Screw	Monel	1
12	03915A	Vent Screw Washer	Polypropylene	1
13	04212B	Upper Diaphragm	Polyester Fabric and EPDM Elastomer	1
14	09865	Lower Diaphragm	Polyester Fabric and EPDM Elastomer	1
15	04547B	Piston	Polycarbonate RTP 301	1
16	04928A	Clapper Assembly	Stainless Steel UNS-S30400 12 ga. & EPDM	1
17	06595A	Screw and Sealing Washer Assembly	Stainless Steel UNS-S30400	2
18	--	Data Plate, Pressure Rating		1

— Indicates replacement part not available.

SUB-ASSEMBLY LIST

6-8, 13-17	13486	Clapper Assembly Kit
---------------	-------	----------------------