



# TECHNICAL DATA

## PILOT REGULATING FLOW CONTROL TRIM

8" (DN200) MODEL J  
FLOW CONTROL VALVE

The Viking Corporation, 210 N Industrial Park Drive, Hastings MI 49058  
Telephone: 269-945-9501 Technical Services: 877-384-5464 Fax: 269-818-1680 Email: techsvcs@vikingcorp.com  
Visit the Viking website for the latest edition of this technical data page: [www.vikinggroupinc.com](http://www.vikinggroupinc.com)

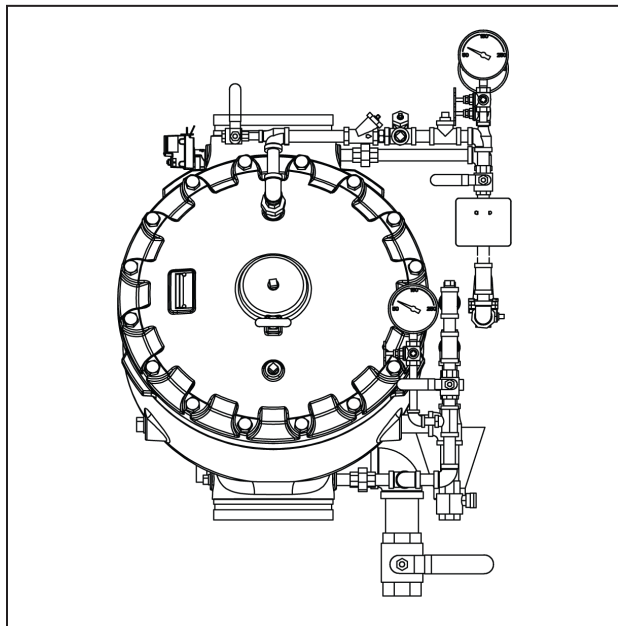

This Trim Chart is for use with  
the following Viking Trim Sets

Valve Size	Galvanized Trim Part No.	Brass Trim Part No.	Stainless Steel Part No.
8" (DN200)	26554-1	26554-2	26554-3

This trim is for use with the following Release Module Trim Kits

Release Type	Galvanized	Brass	Stainless Steel
Electric	10830	10832	10831

**Note:** Nipple lengths for brass trim may vary from those shown on this Trim Chart.



**WARNING:** Cancer and Reproductive Harm-  
[www.P65Warnings.ca.gov](http://www.P65Warnings.ca.gov)

### Notes: For use with Trim Charts on Page 2 and 3

#### General Notes:

- Valve must be trimmed as shown. Any deviation from trim size or arrangement may affect the proper operation of the valve.
- Dimensions in parenthesis are millimeters.
- Viking uses ANSI tee designs (large outlet on run, small outlet on run, side outlet) in all trim call-outs.

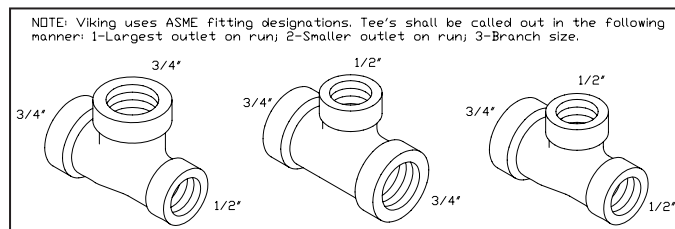

**Note 1:** Release System connection.

**Note 2:** Alarm Connections: Connect alarm line piping to 3/4" (20 mm) NPT outlet. When using a Water Motor Alarm, a strainer is required. 1/2" (15 mm) NPT outlet is for electric Alarm Pressure Switch.

**Note 3:** Optional non-interruptible connection for Alarm Pressure Switch to activate electric alarm panel. Note: After the Deluge Valve trips, this location cannot be shut off. Alarms may operate until the outlet chamber of the deluge valve is de-pressurized below the set point of the Alarm Pressure Switch.

**Note 4:** Viking Drain Check Valve is manufactured with a 0.067" (1.7 mm) orifice to allow alarm line to drain. Do not substitute. Check label for proper orientation.



# TECHNICAL DATA

## PILOT REGULATING FLOW CONTROL TRIM

8" (DN200) MODEL J  
FLOW CONTROL VALVE

The Viking Corporation, 210 N Industrial Park Drive, Hastings MI 49058

Telephone: 269-945-9501 Technical Services: 877-384-5464 Fax: 269-818-1680 Email: techsvcs@vikingcorp.com

Visit the Viking website for the latest edition of this technical data page: [www.vikinggroupinc.com](http://www.vikinggroupinc.com)

ITEM	BOM DESCRIPTION	QTY
1	NIPPLE, 1/4" X 1-1/2"	6
2	NIPPLE, 1/4" X 2"	2
3	NIPPLE, 1/4" X 4"	1
4	NIPPLE, 1/2" X 1-1/2"	10
5	NIPPLE, 1/2" X 2"	8
6	NIPPLE, 1/2" X 3"	2
7	NIPPLE, 1/2" X 3-1/2"	1
8	NIPPLE, 1/2" X 4"	1
9	NIPPLE, 1/2" X 5"	1
10	NIPPLE, 1/2" X 5-1/2"	1
11	NIPPLE, 1/2" X 6"	1
12	NIPPLE, 1/2" X 7"	1
13	NIPPLE, 1/2" X 7-1/2"	1
14	NIPPLE, 1/2" X 10-1/2"	1
15	NIPPLE, 1/2" X 12"	1
16	NIPPLE, 3/4" X 1-1/2"	2
17	NIPPLE, 3/4" X 2"	1
18	NIPPLE, 1" X 3-1/2"	1
19	NIPPLE, 1" X 4"	1
20	NIPPLE, 2" X 4"	2
21	PLUG, 1/4"	4
22	PLUG, 1/2"	8
23	PLUG, 3/4"	1
24	PLUG, 1"	1
25	PLUG, 2"	1
26	ELBOW, 1/4"	1
27	ELBOW, 1/2"	6
28	ELBOW, 2"	1
29	TEE, 1/2"	5
30	TEE, 1/2" X 1/4" X 1/2"	4
31	TEE, 1/2" X 1/2" X 1/4"	1
32	TEE, 3/4" X 1/2" X 1/2"	1
33	TEE, 3/4" X 1/2" X 3/4"	1
34	TEE, 1" X 3/4" X 1"	1
35	UNION, 1/4"	1
36	UNION, 1/2"	4
37	UNION, 3/4"	1
38	BALL VALVE, 1/4"	2
39	BALL VALVE, 1/2"	3
40	BALL VALVE, 1"	1
41	BALL VALVE, 2"	1
42	CHECK VALVE, 1/4"	1
43	DRAIN CHECK VALVE	1
44	DRIP CHECK VALVE	1
45	DRAIN CUP	1
46	PRESSURE GAUGE, WATER	3
47	RESTRICTION, .0625	1
48	RESTRICTION, 1/16"	1
49	SIDE OUTLET VALVE, 1/4"	3
50	STRAINER, 1/4"	1
51	STRAINER, 1/2"	1
52	PILOT PRESSURE REGULATOR	1
53	PRESSURE RELIEF VALVE	1
54	EMERGENCY RELEASE TAG KIT	1

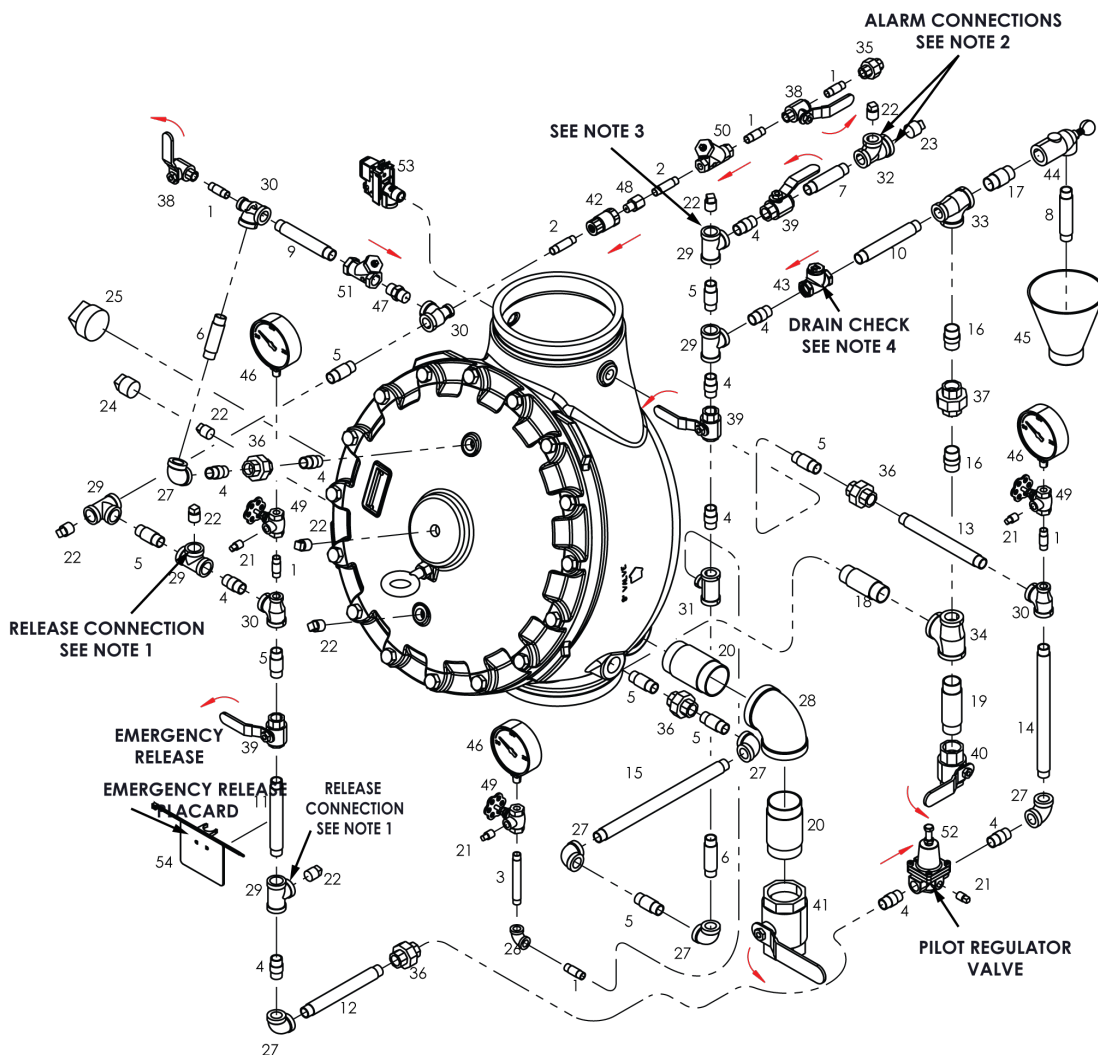

Refer to page 1 for  
General Notes and  
Notes 1 through 4.

Order Flow Control Valve  
Separately

**Figure 1**  
**8" Pilot Regulating Trim for Model J Flow Control Valve**  
**(Part number 26554-1 and 26554-2)**



# TECHNICAL DATA

## PILOT REGULATING FLOW CONTROL TRIM

8" (DN200) MODEL J  
FLOW CONTROL VALVE

The Viking Corporation, 210 N Industrial Park Drive, Hastings MI 49058

Telephone: 269-945-9501 Technical Services: 877-384-5464 Fax: 269-818-1680 Email: techsvcs@vikingcorp.com

Visit the Viking website for the latest edition of this technical data page: [www.vikinggroupinc.com](http://www.vikinggroupinc.com)

ITEM	BOM DESCRIPTION	REQ.
1	NIPPLE, 1/4" X 1-1/2"	5
2	NIPPLE, 1/4" X 2"	2
3	NIPPLE, 1/4" X 3"	2
4	NIPPLE, 1/2" X 1-1/2"	9
5	NIPPLE, 1/2" X 2"	9
6	NIPPLE, 1/2" X 3"	2
7	NIPPLE, 1/2" X 3-1/2"	1
8	NIPPLE, 1/2" X 4"	1
9	NIPPLE, 1/2" X 5"	2
10	NIPPLE, 1/2" X 6"	1
11	NIPPLE, 1/2" X 7"	1
12	NIPPLE, 1/2" X 7-1/2"	1
13	NIPPLE, 1/2" X 10-1/2"	1
14	NIPPLE, 1/2" X 12"	1
15	NIPPLE, 3/4" X 1-1/2"	2
16	NIPPLE, 3/4" X 2"	1
17	NIPPLE, 2" X 4"	2
18	NIPPLE, 1" X 3-1/2"	1
19	NIPPLE, 1" X 4"	1
20	PLUG, 1/4"	1
21	PLUG, 1/2"	9
22	PLUG, 1"	1
23	PLUG, 2"	1
24	REDUCING BUSHING, 1/2" X 1/4"	5
25	REDUCING BUSHING, 3/4" X 1/2"	1
26	REDUCING BUSHING, 1" X 3/4"	1
27	ELBOW, 1/4"	1
28	ELBOW, 1/2"	6
29	ELBOW, 2"	1
30	TEE, 1/2"	11
31	TEE, 3/4"	1
32	TEE, 1"	1
33	UNION, 1/4"	1
34	UNION, 1/2"	4
35	UNION, 3/4"	1
36	BALL VALVE, 1/4"	5
37	BALL VALVE, 1/2"	3
38	BALL VALVE, 1"	1
39	BALL VALVE, 2"	1
40	CHECK VALVE, 1/4"	1
41	DRAIN CHECK VALVE	1
42	DRIP CHECK VALVE	1
43	DRAIN CUP	1
44	PRESSURE GAUGE, WATER	3
45	RESTRICTION, .0625	1
46	RESTRICTION, 1/16"	1
47	STRAINER, 1/4"	1
48	STRAINER, 1/2"	1
49	PILOT PRESSURE REGULATOR	1
50	PRESSURE RELIEF VALVE	1
51	EMERGENCY RELEASE TAG KIT	1

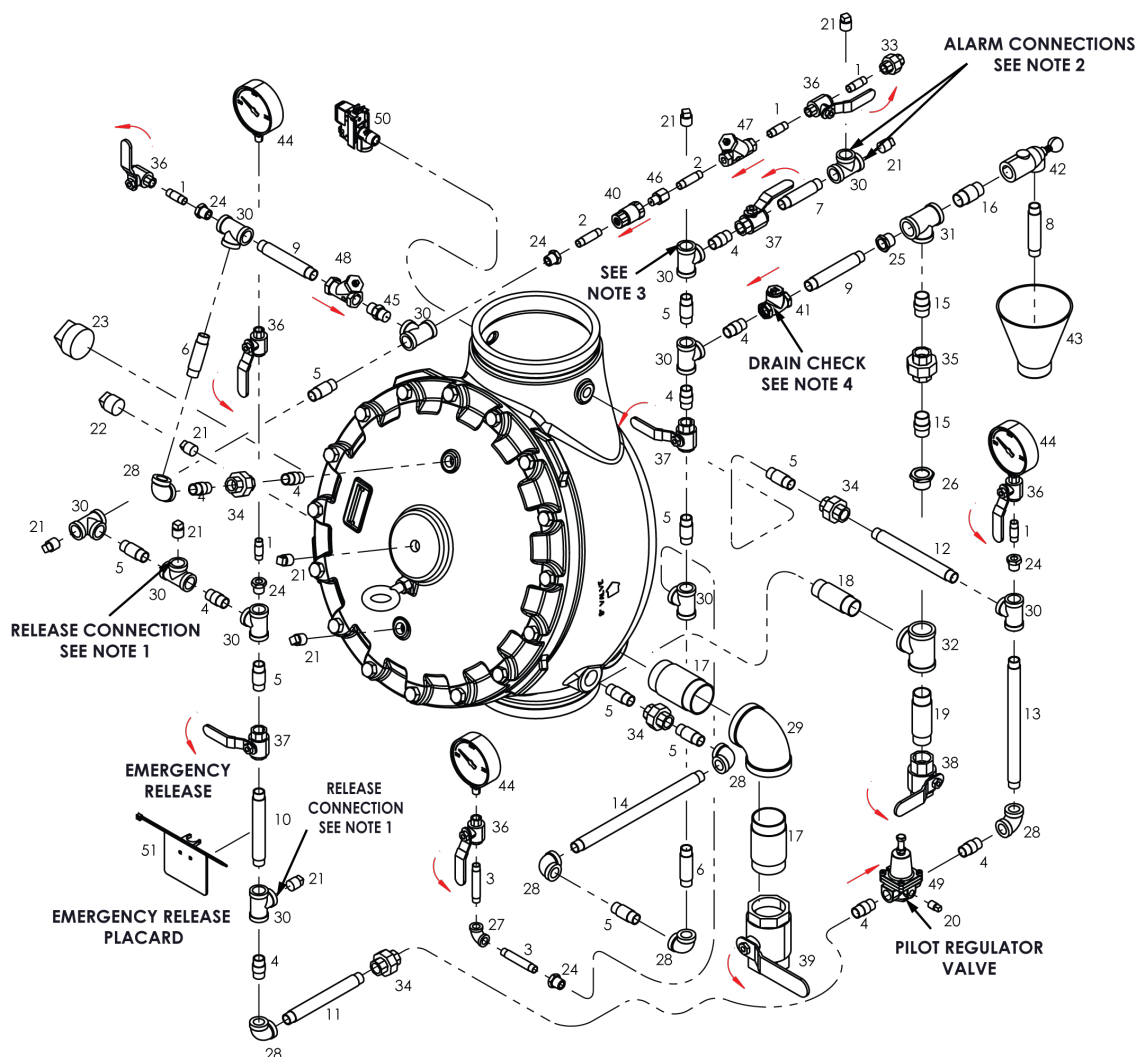

Refer to page 1 for  
General Notes and  
Notes 1 through 4.

Order Flow Control Valve  
Separately

**Figure 2**  
**8" Stainless Steel Pilot Regulating Trim for Model J Flow Control Valve**  
**(Part number 26554-3)**



# TECHNICAL DATA

## PILOT REGULATING FLOW CONTROL TRIM

8" (DN200) MODEL J  
FLOW CONTROL VALVE

The Viking Corporation, 210 N Industrial Park Drive, Hastings MI 49058  
Telephone: 269-945-9501 Technical Services: 877-384-5464 Fax: 269-818-1680 Email: techsvcs@vikingcorp.com  
Visit the Viking website for the latest edition of this technical data page: [www.vikinggroupinc.com](http://www.vikinggroupinc.com)

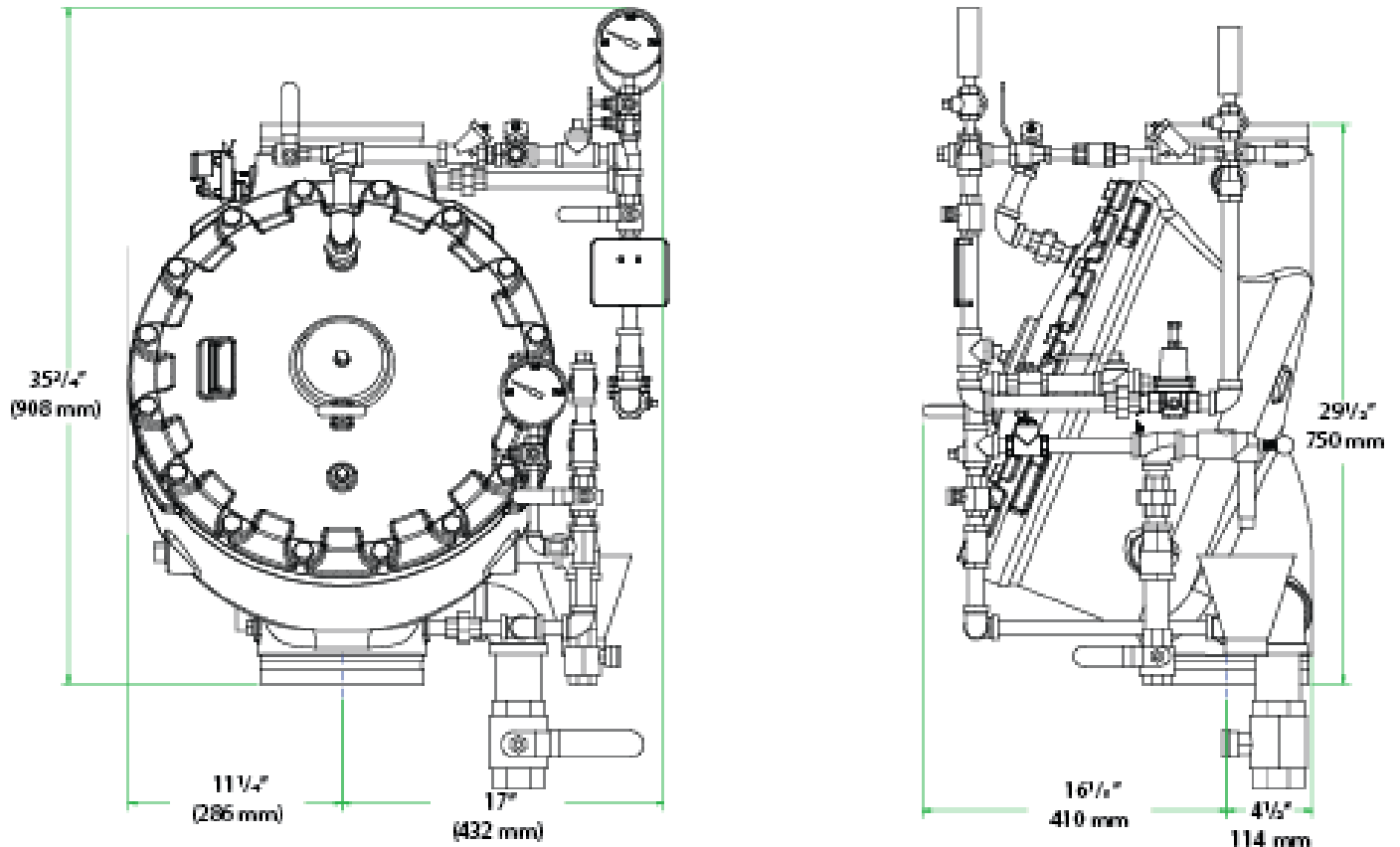

Figure 3 - Installation Dimensions