

Job Name _____
 Job Location _____
 Engineer _____
 Approval _____

Contractor _____
 Approval _____
 Contractor's P.O. No. _____
 Representative _____

LEAD FREE*

Colt™ Series

C200 (Colt 200), C200N (Colt 200N)

Double Check Valve Assemblies

Sizes: 2½" – 10"

The Colt C200, C200N Double Check Valve Assemblies are used to prevent backflow of pollutants, that are objectionable but not toxic, from entering the potable water supply system. The Colt C200, C200N may be installed under continuous pressure service and may be subjected to backpressure. The Colt C200, C200N consists of two independently operating check valves, two shutoff valves, and four test cocks. For use in non-health hazard applications. The Colt C200, C200N features Lead Free* construction to comply with Lead Free* installation requirements.

Features

- Extremely Compact Design
- 70% Lighter than Traditional Designs
- 304 (Schedule 40) Stainless Steel Housing & Sleeve
- Groove Fittings Allow Integral Pipeline Adjustment
- Patented Tri-Link Check Provides Lowest Pressure Loss
- Unmatched Ease of Serviceability
- Available with Grooved Butterfly Valve Shutoffs
- Available for Horizontal, Vertical or N Pattern Installations
- Replaceable Check Disc Rubber

Specifications

The Colt C200, C200N Double Check Valve Assembly shall consist of two independent Tri-Link Check modules within a single housing, sleeve access port, four test cocks and two drip tight shutoff valves. Tri-Link Checks shall be removable and serviceable, without the use of special tools. The housing shall be constructed of 304 (Schedule 40) stainless steel pipe with groove end connections. Tri-Link checks shall have reversible elastomer discs and in operation shall produce drip tight closure against the reverse flow of liquid caused by backpressure or backsiphonage. Lead Free* Double Check Valve Assembly shall be constructed using Lead Free* materials. It shall comply with state codes and standards, where applicable, requiring reduced lead content. Assembly shall be an Ames Fire & Waterworks Colt C200, C200N.

Ames Fire & Waterworks product specifications in U.S. customary units and metric are approximate and are provided for reference only. For precise measurements, please contact Ames Fire & Waterworks Technical Service. Ames Fire & Waterworks reserves the right to change or modify product design, construction, specifications, or materials without prior notice and without incurring any obligation to make such changes and modifications on Ames Fire & Waterworks products previously or subsequently sold.

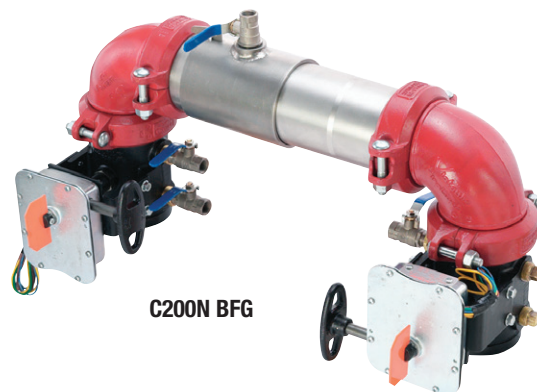
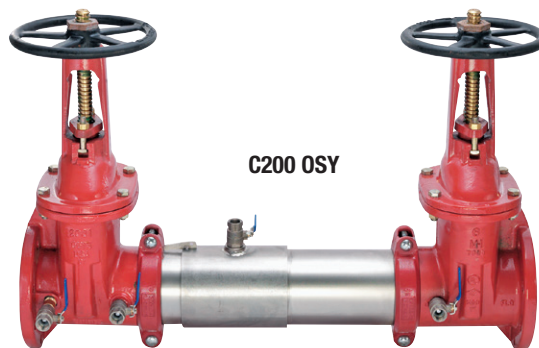

NOTICE

The information contained herein is not intended to replace the full product installation and safety information available or the experience of a trained product installer. You are required to thoroughly read all installation instructions and product safety information before beginning the installation of this product.

*The wetted surface of this product contacted by consumable water contains less than 0.25% of lead by weight.

AMES
 FIRE & WATERWORKS
 A WATTS Brand

Configurations

- Horizontal
- Vertical up
- "N" pattern horizontal

Materials

- Housing & Sleeve: 304 (Schedule 40) Stainless Steel
- Elastomers: EPDM, Silicone and Buna 'N'
- Tri-Link Checks: Noryl®, Stainless Steel
- Check Discs: Reversible Silicone or EPDM
- Test Cocks: Lead Free* Bronze Body
- Pins & Fasteners: 300 Series Stainless Steel
- Springs: Stainless Steel

Available Models

Suffix:

NRS — non-rising stem resilient seated gate valves

OSY — UL/FM outside stem and yoke, resilient seated gate valves

BFG — UL/FM grooved gear operated butterfly valves with tamper switch

*OSY FxG — Flanged inlet gate connection and grooved outlet gate connection

*OSY GxG — Grooved inlet gate connection and flanged outlet gate connection

*OSY GxG — Grooved inlet gate connection and grooved outlet gate connection

Available with grooved NRS gate valves - consult factory*

Post indicator plate and operating nut available — consult factory*

*Consult factory for dimensions

Pressure – Temperature

Temperature Range: 33°F – 140°F (0.5°C – 60°C)

Maximum Working Pressure: 175 psi (12.1 bar)

Dimensions – Weights

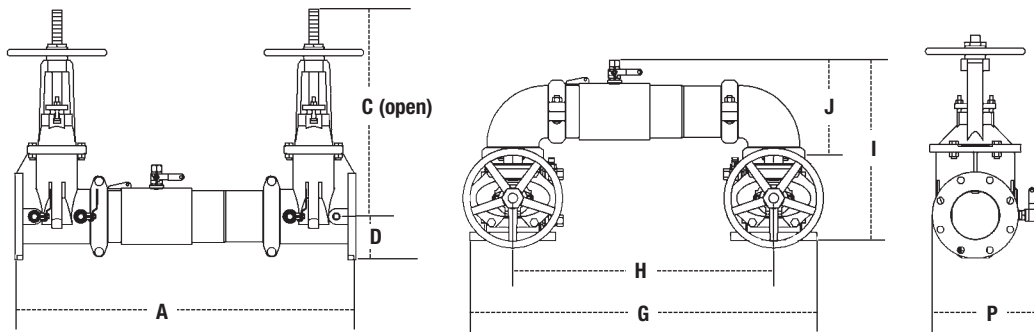

C200, C200N

| SIZE | DIMENSIONS | | | | | | | | | | WEIGHT | | | | | | | | | | | | | | | |
|------|------------|------|---------|------|---------|-----|-----|-----|-----|------|--------|------|-----|-----|-----|-----|-----|-----|---------|------|---------|------|-----------|------|-----------|------|
| | A | | C (OSY) | | C (NRS) | | D | | G | | H | | I | | J | | P | | C200NRS | | C200OSY | | C200N NRS | | C200N OSY | |
| in. | in. | mm | in. | mm | in. | mm | in. | mm | in. | mm | in. | mm | in. | mm | in. | mm | in. | mm | lbs. | kgs. | lbs. | kgs. | lbs. | kgs. | lbs. | kgs. |
| 2½ | 30¾ | 781 | 16¾ | 416 | 9¾ | 238 | 3½ | 89 | 29⅞ | 738 | 21½ | 546 | 15½ | 393 | 8⅜ | 223 | 9⅞ | 234 | 115 | 52 | 125 | 57 | 123 | 56 | 133 | 60 |
| 3 | 31¾ | 806 | 18¾ | 479 | 10¼ | 260 | 3⅞ | 94 | 30¼ | 768 | 22¼ | 565 | 17⅞ | 435 | 9⅞ | 233 | 10½ | 267 | 131 | 59 | 145 | 66 | 144 | 65 | 158 | 72 |
| 4 | 33¾ | 857 | 22¾ | 578 | 12¾ | 310 | 4 | 102 | 33 | 838 | 23½ | 597 | 18½ | 470 | 9⅞ | 252 | 11¾ | 284 | 161 | 73 | 161 | 73 | 184 | 83 | 184 | 83 |
| 6 | 43½ | 1105 | 30¾ | 765 | 16 | 406 | 5½ | 140 | 44¾ | 1137 | 33¼ | 845 | 23¾ | 589 | 13⅞ | 332 | 15 | 381 | 273 | 124 | 295 | 134 | 314 | 142 | 336 | 152 |
| 8 | 49¾ | 1264 | 37¾ | 959 | 19⅞ | 506 | 6⅞ | 170 | 54¼ | 1375 | 40⅞ | 1019 | 27⅞ | 697 | 15⅞ | 399 | 17¾ | 437 | 438 | 199 | 480 | 218 | 513 | 233 | 555 | 252 |
| 10 | 57¾ | 1467 | 45¾ | 1162 | 23⅞ | 605 | 8¾ | 208 | 66 | 1676 | 49½ | 1257 | 32½ | 826 | 17¾ | 440 | 20 | 508 | 721 | 327 | 781 | 354 | 891 | 404 | 951 | 431 |

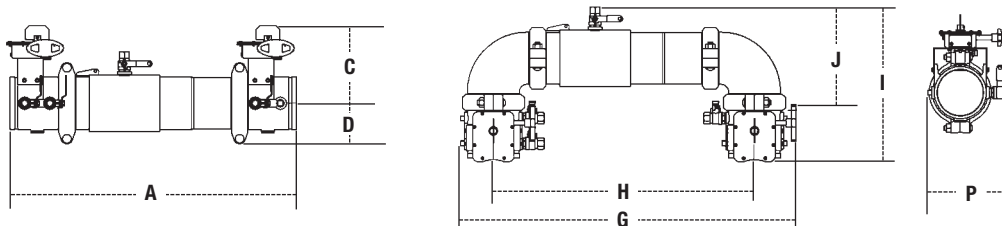

C200BFG, C200NBFG

| SIZE | DIMENSIONS | | | | | | | | | | WEIGHT | | | | | | | | | |
|------|------------|------|-----|-----|-----|-----|-----|------|-----|------|--------|-----|-----|-----|-----|-----|---------|------|----------|------|
| | A | | C | | D | | G | | H | | I | | J | | P | | C200BFG | | C200NBFG | |
| in. | in. | mm | in. | mm | in. | mm | in. | mm | in. | mm | in. | mm | in. | mm | in. | mm | lbs. | kgs. | lbs. | kgs. |
| 2½ | 27¾ | 705 | 8 | 203 | 3½ | 89 | 29⅞ | 759 | 21½ | 546 | 14⅞ | 379 | 8⅜ | 223 | 9 | 229 | 56 | 25 | 64 | 29 |
| 3 | 28¼ | 718 | 8⅞ | 211 | 3⅞ | 94 | 30⅞ | 779 | 22¼ | 565 | 15⅞ | 392 | 9⅞ | 233 | 9½ | 241 | 54 | 24 | 67 | 30 |
| 4 | 29 | 737 | 8⅞ | 227 | 3⅞ | 94 | 31⅞ | 811 | 23½ | 597 | 16¼ | 412 | 9⅞ | 252 | 10 | 254 | 61 | 28 | 84 | 38 |
| 6 | 36½ | 927 | 10 | 254 | 5 | 127 | 43⅞ | 1097 | 33¼ | 845 | 19⅞ | 500 | 13⅞ | 332 | 10½ | 267 | 117 | 53 | 157 | 71 |
| 8 | 42¾ | 1086 | 12¼ | 311 | 6½ | 165 | 51⅞ | 1297 | 40⅞ | 1019 | 23¾ | 592 | 15⅞ | 399 | 14¾ | 361 | 261 | 118 | 337 | 153 |

Approvals

- Approved by the Foundation for Cross-Connection Control and Hydraulic Research at The University of Southern California (FCCCHR-USC)

- AWWA C510-97

For additional approval information please contact the factory or visit our website at www.amesfirewater.com



1015



B64.5



(**BFG & OSY Only)



Approved



Certified to NSF/ANSI 61-G

_____ Horizontal _____ Vertical - - - - - N - Pattern

2 1/2"

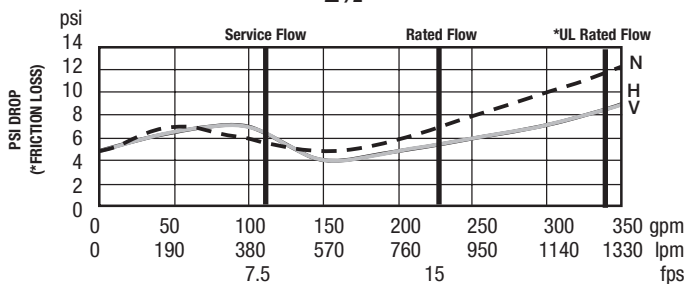

6"

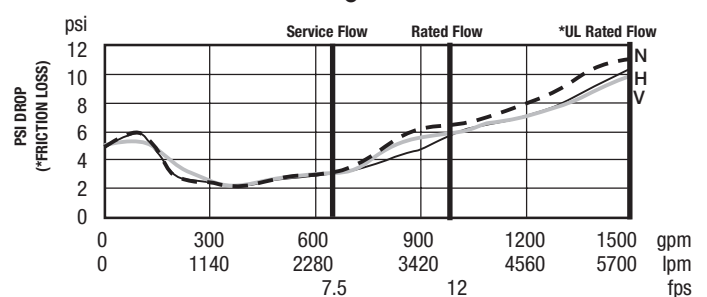

3"

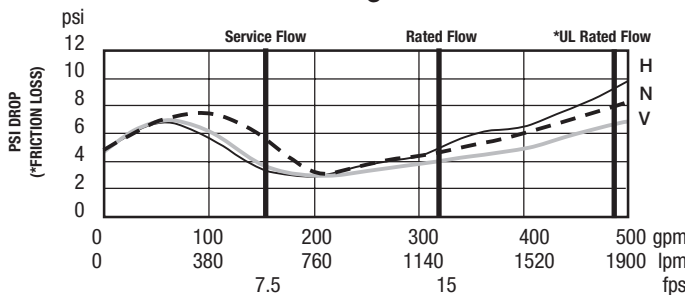

8"

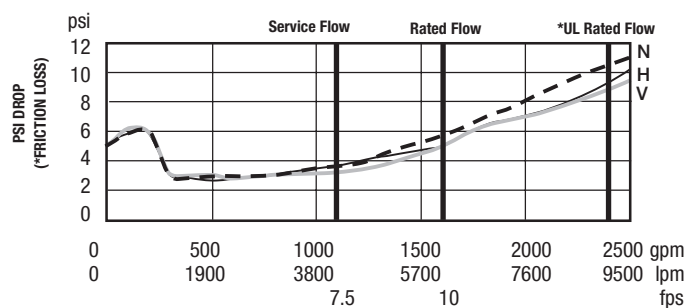

4"

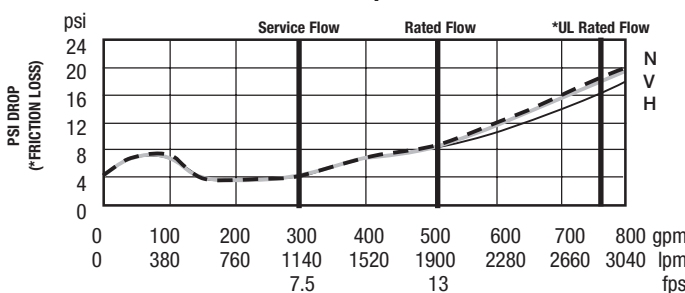

10"

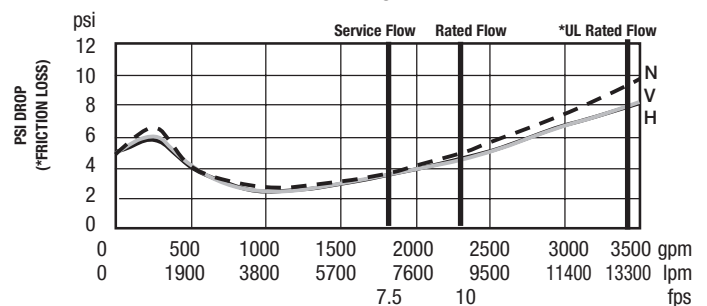

Capacity

UL/FM Certified Flow Characteristics

Flow characteristics collected using butterfly shutoff valves.

Flow capacity chart identifies valve performance based upon rated water velocity up to 25fps

- Service Flow is typically determined by a rated velocity of 7.5fps based upon schedule 40 pipe.
- Rated Flow identifies maximum continuous duty performance determined by AWWA.
- UL Flow Rate is 150% of Rated Flow and is not recommended for continuous duty.
- AWWA Manual M22 [Appendix C] recommends that the maximum water velocity in services be not more than 10fps.

NOTICE

Inquire with governing authorities for local installation requirements



A WATTS Brand

USA: Backflow Tel: (978) 689-6066 • Fax: (978) 975-8350 • AmesFireWater.com
USA: Control Valves Tel: (713) 943-0688 • Fax: (713) 944-9445 • AmesFireWater.com
Canada: Tel: (905) 332-4090 • Fax: (905) 332-7068 • AmesFireWater.ca
Latin America: Tel: (52) 55-4122-0138 • AmesFireWater.com